

## DASH MOUNT

2022-2023/TOYOTA TUNDRA

R2223TTUNDM

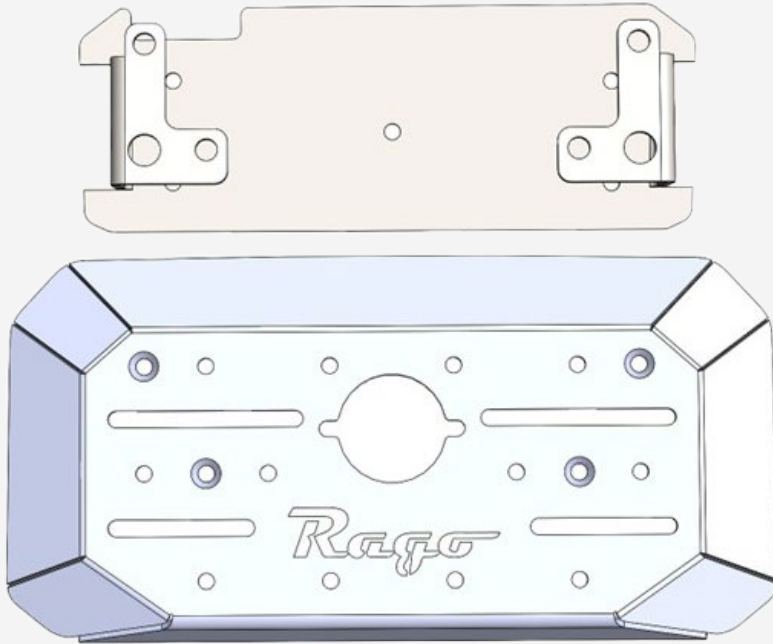

### TOOLS REQUIRED

- 7/16, 11/32 wrench
- 9/32 Drill Bit
- 5/32, 5/16, 5/64 Hex
- Drill

### SKILL LEVEL

- Easy

### TIME REQUIRED

- Approximately 1 Hour

## WARNINGS/CAUTIONS BEFORE STARTING INSTALLATION

### -BEFORE YOU INSTALL THIS KIT-

Read and understand all instructions, warnings, cautions, & notes contained in this installation instruction guide. Consult your vehicle owner's manual for proper disconnection of electrical and lifting of vehicle if required for installation of this product.

This install may require some technical skills and knowledge of basic mechanical work. If you do not feel that you are capable of performing this install please take this product to a trained professional.

After reading this guide please contact us with any questions or concerns before installing product.

Customer Service: 830-896-7571  
Rago Fabrication is not responsible for any bodily injury or harm to you or your vehicle as a result of an improper install.

Proper installation of this kit required knowledge of the factory recommended procedures for removal and installation of original equipment components.

We recommend that the factory shop manual and any special tools needed to service your vehicle be on hand during the installation. Installation of this kit without proper knowledge of the factory recommended procedures may affect the

performance of these components and the safety of the vehicle. Inspect all contents of this package to make sure product is not damaged and all installation hardware has been included. If parts are missing from kit, please be prepared to provide the following information:

1. Name of purchase location
2. Bar Code on side of box
3. Date above bar code
4. Date inside box cover

**\*ALWAYS WEAR EYE PROTECTION WHEN OPERATING POWER TOOLS\***

## HARDWARE

**A.**

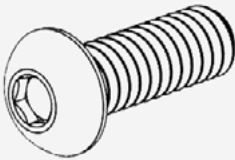

1/4-20 X 3/4" BUTTON HEAD

**QTY: 5**

**A1.**



1/4" FLAT WASHER

**QTY: 5**

**A2.**

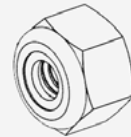

1/4-20" Nylon Lock Nut

**QTY: 5**

**B.**

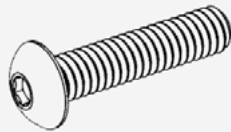

#8-32 X 3/4" Button Head Bolt

**QTY: 2**

**B1.**

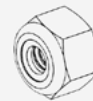

#8-32 Nylon Lock Nut

**QTY: 2**

**C.**

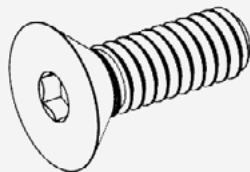

1/4-20 X 3/4" Button Head Bolt

**QTY: 4**

**D.**

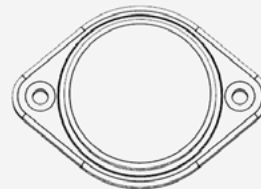

USB Charger

**QTY: 1**

Reference this page throughout the install



**STEP 1**

Remove the dash tray by pulling up.



## □ STEP 2

Place the dash mount inside of the dash tray. Mark the holes and remove the dash mount.



## □ STEP 3

Drill the holes you marked on **step 2** with a (drill) and a (9/32 drill bit).



## □ STEP 4

Place the dash mount in the dash tray and insert bolts (A, A1, A2) and tighten using a (5/16 hex) and a (7/16 wrench).

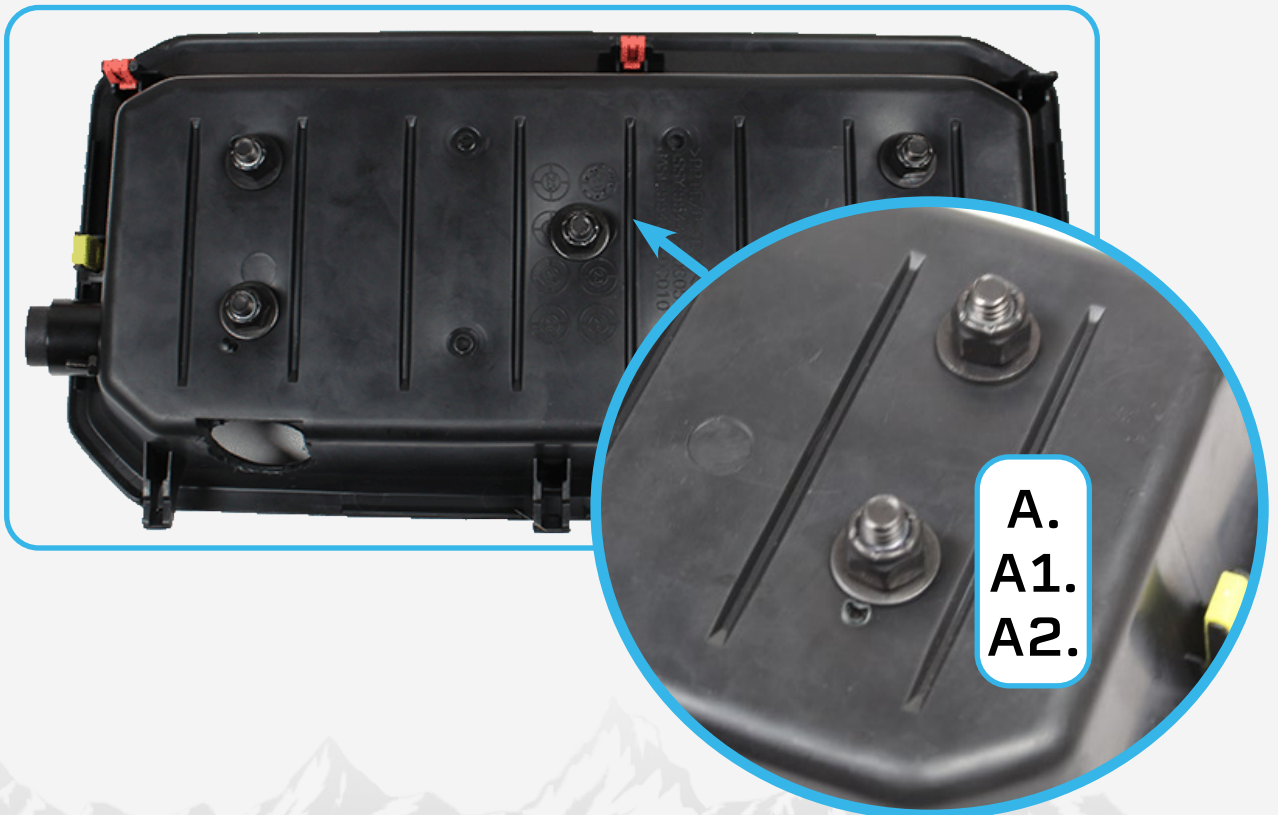

## □ STEP 5

Install the USB charger (**D**) using hardware (**B, B1**) with a (5/64 hex) and a (11/32 wrench). (**DO NOT over tighten due to breakage**)



**STEP 6**

Install the dash tray with the dash mount back into the vehicle.





## □ STEP 7

Install the dash plate using hardware **(C)** with a (5/32 hex).

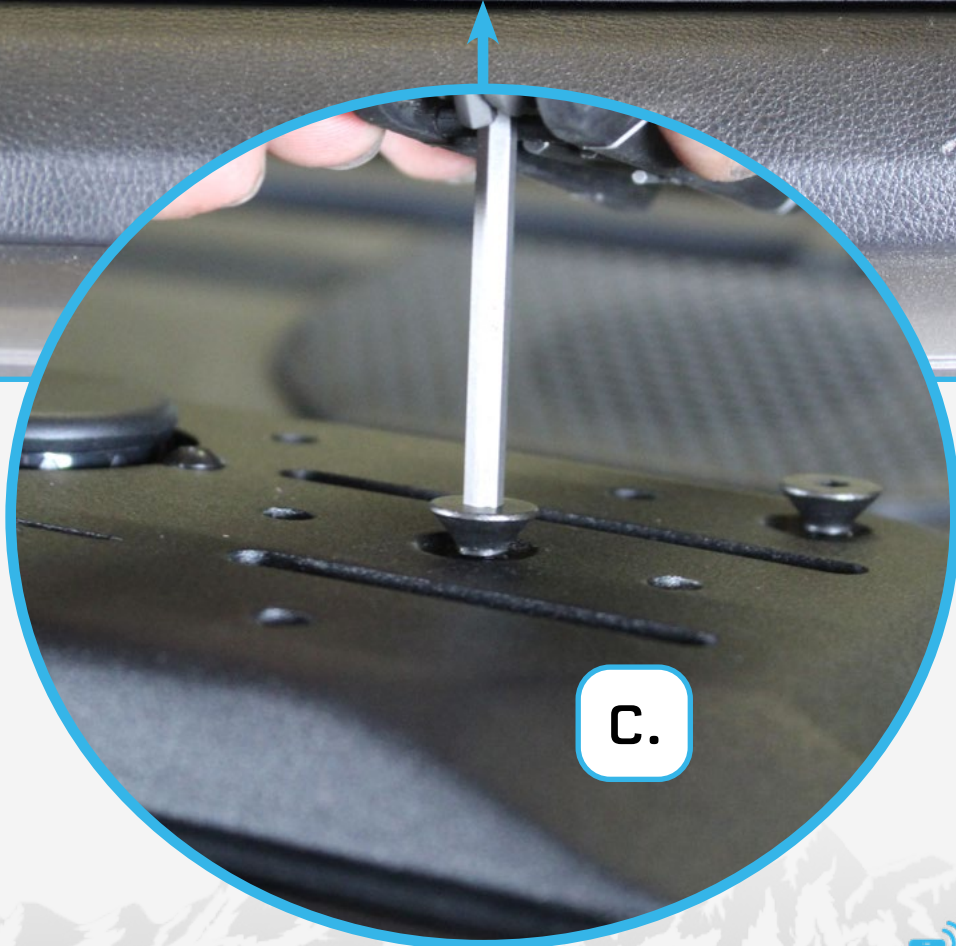
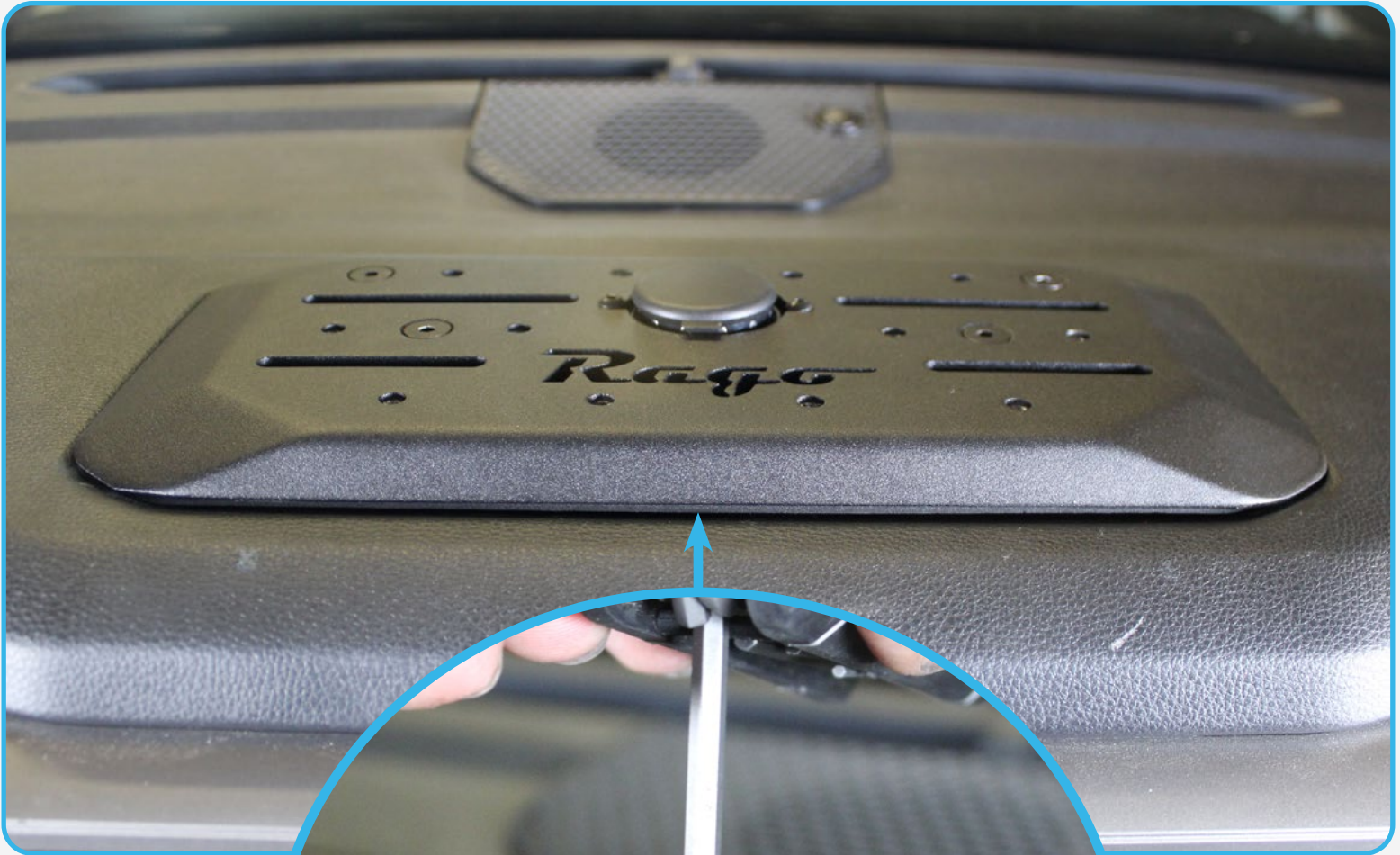

**C.**

## STEP 8

Double check all hardware and fitment for security.

Enjoy your new Rago Dash Mount.

