

AC6502801NA 2022-UP INEOS GRENADIER RAGO REAR WINDOW MSP



TOOLS REQUIRED

- 7/16 Sockets
- 7/16 Wrenches
- Pushpin Puller or Flathead Screwdriver
- Rivet Nut Hand Tool
- 5/32, 5mm Hex
 - Marker
 - Ruler
- Masking Tape
- Drill
 - Step Drill Bit



SKILL LEVEL

- Medium



TIME REQUIRED

- Approximately 45 Minutes

⚠ WARNINGS/CAUTIONS BEFORE STARTING INSTALLATION ⚠

-BEFORE YOU INSTALL THIS KIT-

Read and understand all instructions, warnings, cautions, & notes contained in this installation instruction guide. Consult your vehicle owner's manual for proper disconnection of electrical and lifting of vehicle if required for installation of this product.

This install may require some technical skills and knowledge of basic mechanical work. If you do not feel that you are capable of performing this install please take this product to a trained professional.

After reading this guide please contact us with any questions or concerns before installing product.

Customer Service: 830-896-7571
Rago Fabrication is **not** responsible for any bodily injury or harm to you or your vehicle as a result of an improper install.

Proper installation of this kit required knowledge of the factory recommended procedures for removal and installation of original equipment components.

We recommend that the factory shop manual and any special tools needed to service your vehicle be on hand during the installation. Installation of this kit without proper knowledge of the factory recommended procedures may affect the

performance of these components and the safety of the vehicle. Inspect all contents of this package to make sure product is not damaged and all installation hardware has been included. If parts are missing from kit, please be prepared to provide the following information:

1. Name of purchase location
2. Bar Code on side of box
3. Date above bar code
4. Date inside box cover

***ALWAYS WEAR EYE PROTECTION
WHEN OPERATING POWER TOOLS***

HARDWARE

A.



1/4-20 X 5/16" BUTTON HEAD BOLT

QTY: 12

A1.



1/4-20 X 3/4" BUTTON HEAD BOLT

QTY: 8

A2.



1/4-20" RIVET NUT

QTY: 8

A3.



M6 FLAT WASHER

QTY: 20

B.

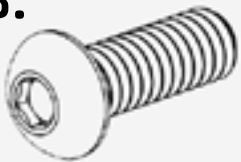

M8-1.25MM X 30MM BUTTON HEAD BOLT

QTY: 4

B1.



M8 WASHER

QTY: 4

B2.



M8 RETAINING WASHER

QTY: 4

C.



3/4" SPACER

QTY: 4

D.

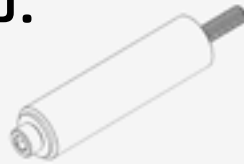

MPL0038

QTY: 4

Reference this page throughout the install



□ STEP 1

Using a (T45 Torx) remove the (2) cargo hooks located below.



□ STEP 2

Installed the provided (D) threaded spacers into the holes revealed on **Step 1**.

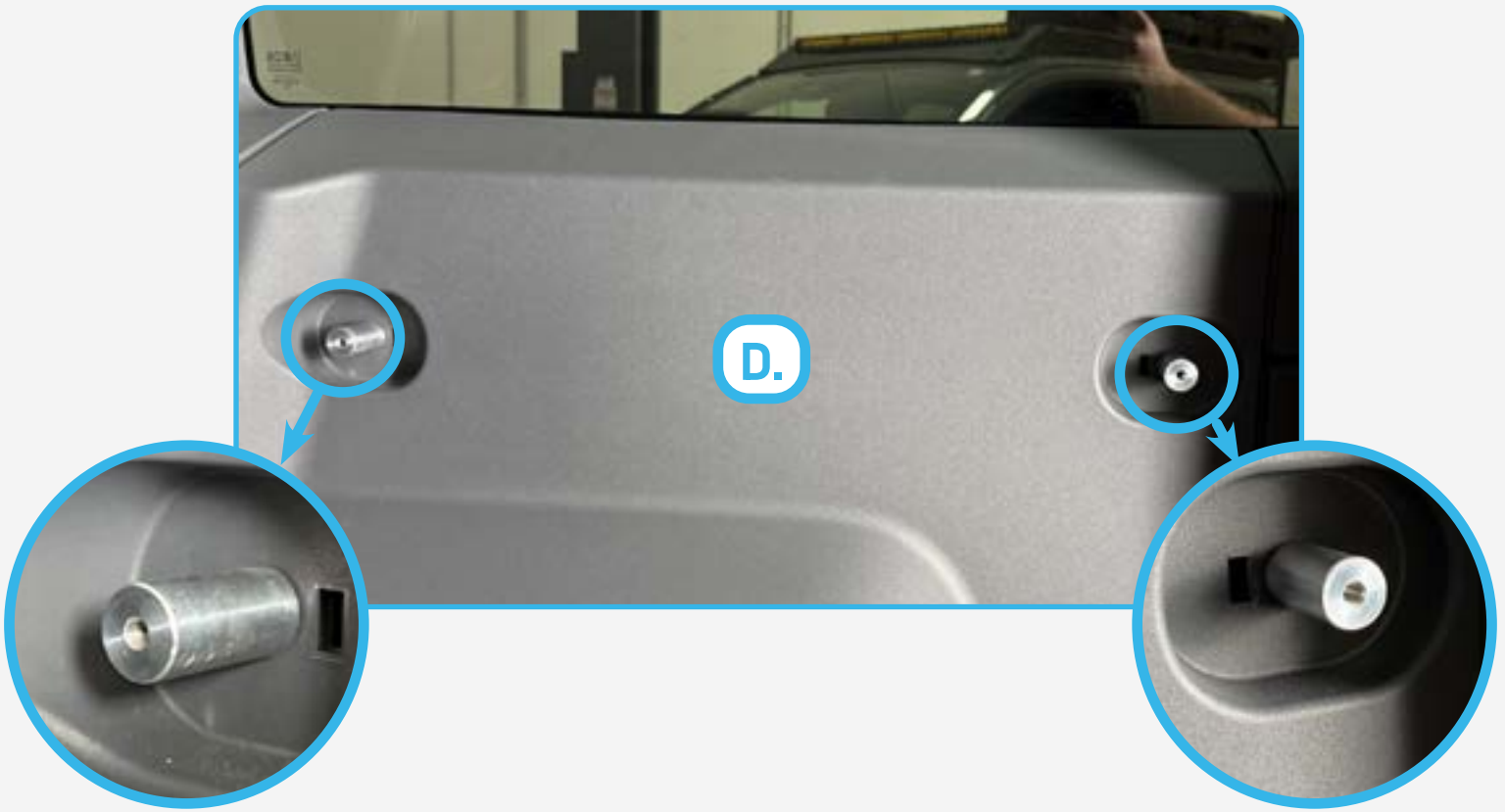

□ STEP 3

Install the lower half of the MOLLE panel into the spacers installed on **Step 2** using the provided spacer hardware and then mark the holes as shown below.

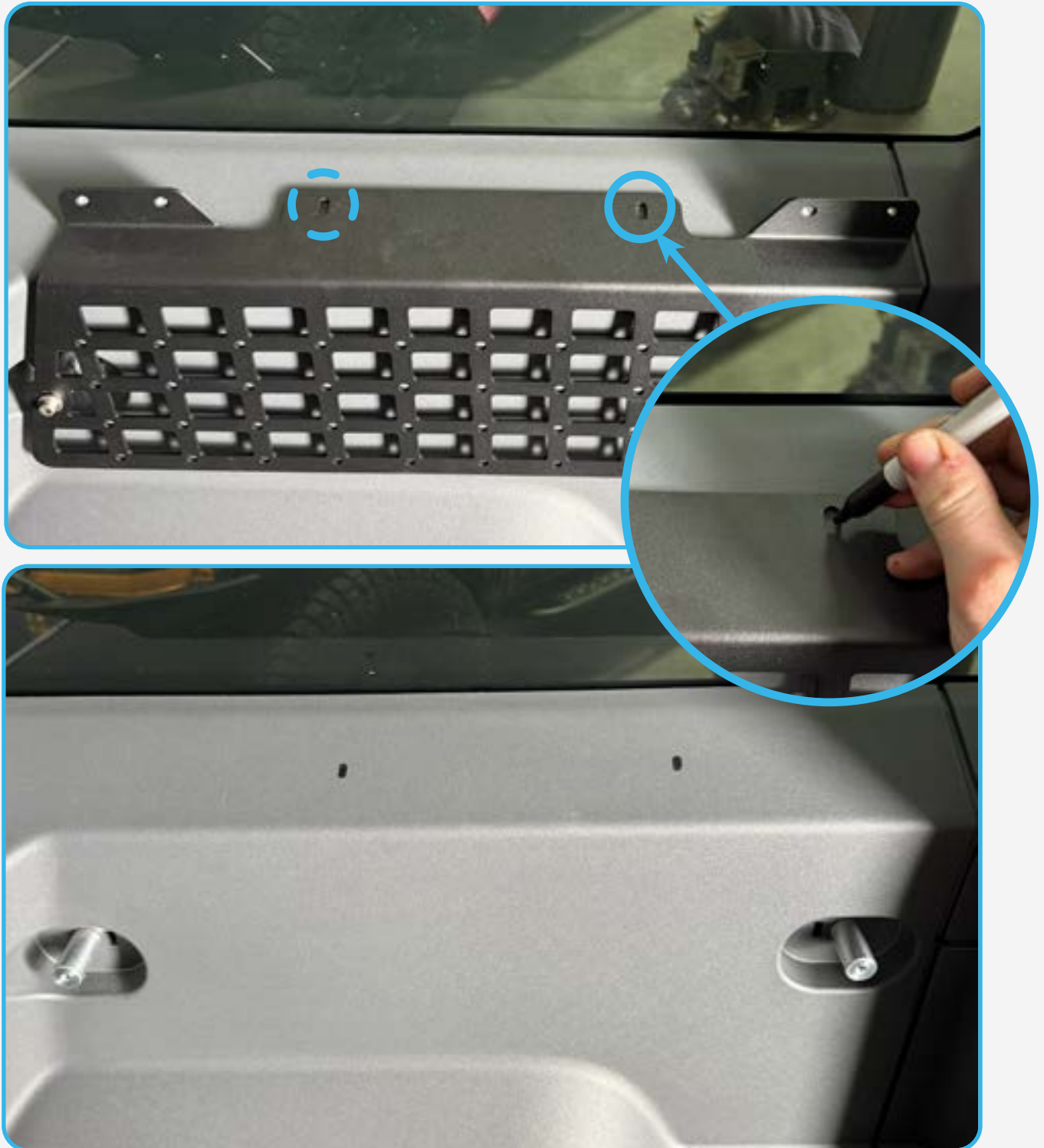

□ STEP 4

Remove the lower MOLLE panel. Then drill a 25/64 hole at the points marked in **Step 3**. Then use a [\(rivet nut installation tool\)](#) to install the provided [\(A2\)](#) 1/4-20 rivet nut.



□ STEP 5

Reinstall the lower section of the MOLLE panel by utilizing the provided spacer hardware and the 1/4" hardware (A1, A3) into the rivetnuts installed on **Step 4**.
[Apply blue loctite to all hardware]

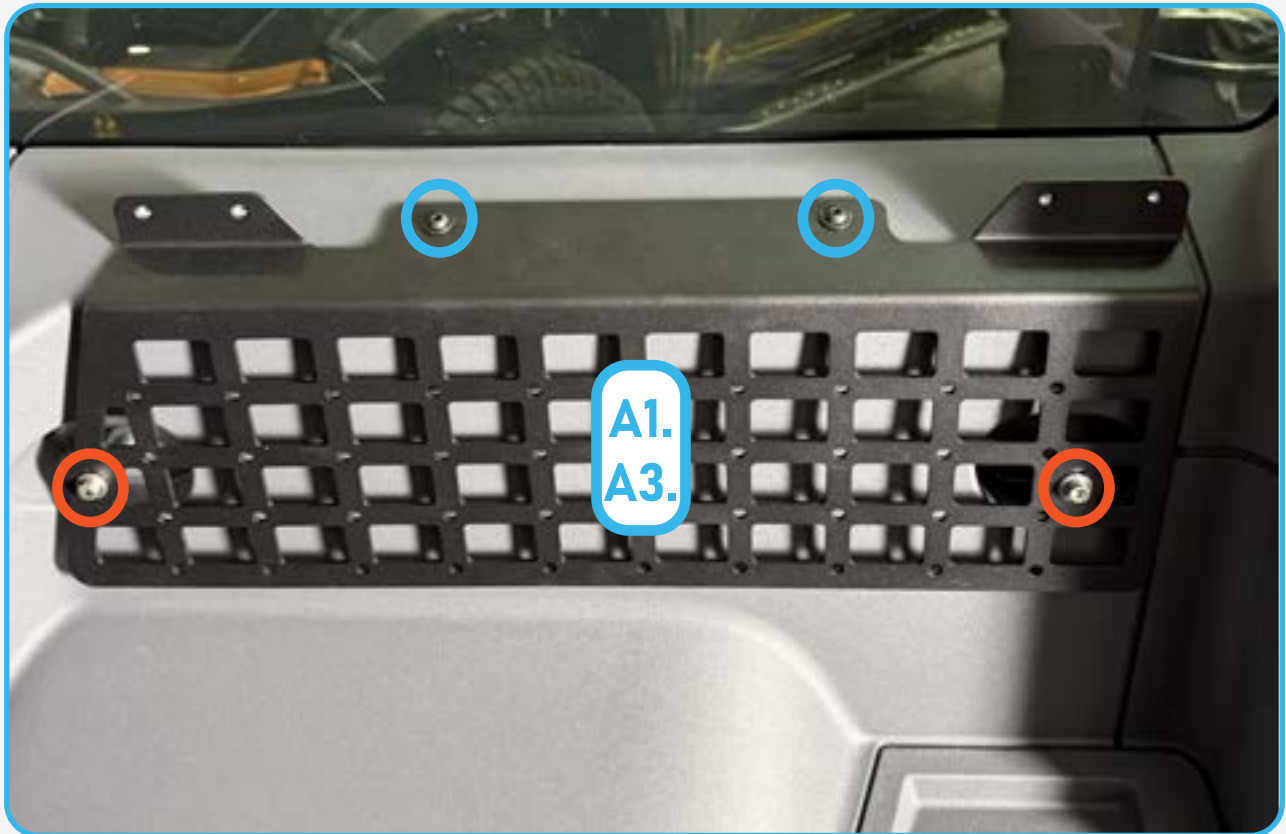

□ STEP 6

Using the provided [A, A3] 1/4" hardware and a 5/32 allen, loosely install the support bracket as shown below.

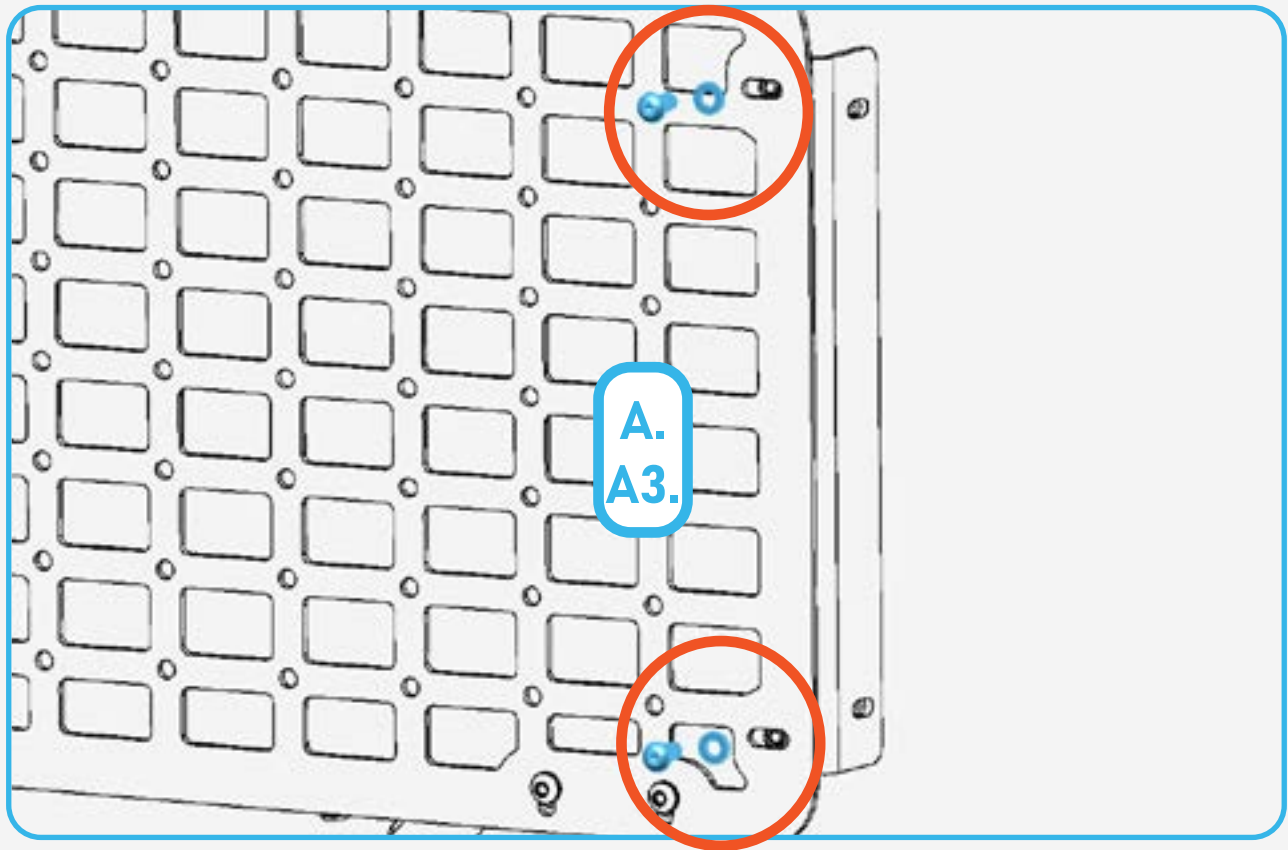

□ STEP 7

Install the upper MOLLE panel to the lower MOLLE panel using a (5/32 allen) and the provided (A, A3) 1/4" hardware.

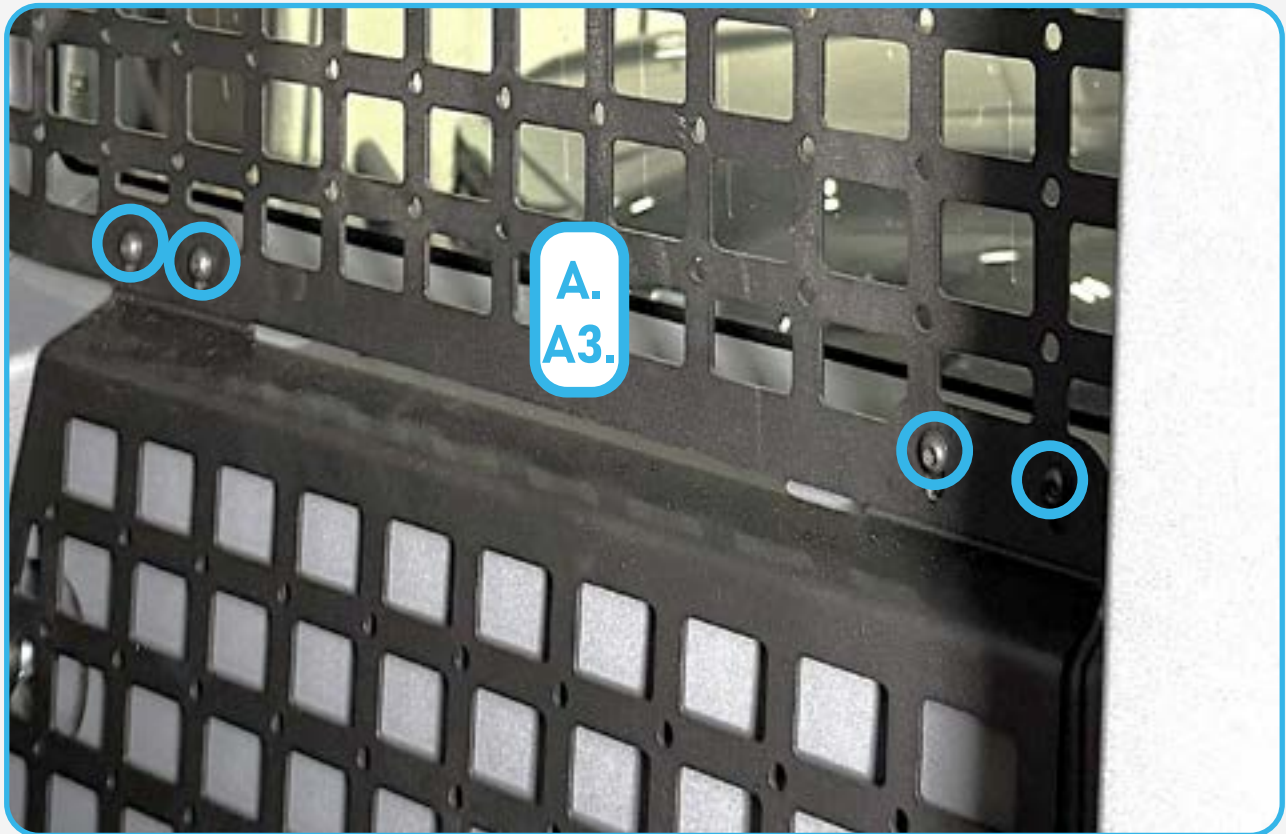

□ STEP 8

Mark the points on the plastic cover panels as shown below.



□ STEP 9

Mark the (2) mounting holes for the support bracket indicated in the areas below. You can now remove the upper half of the MOLLE panel.

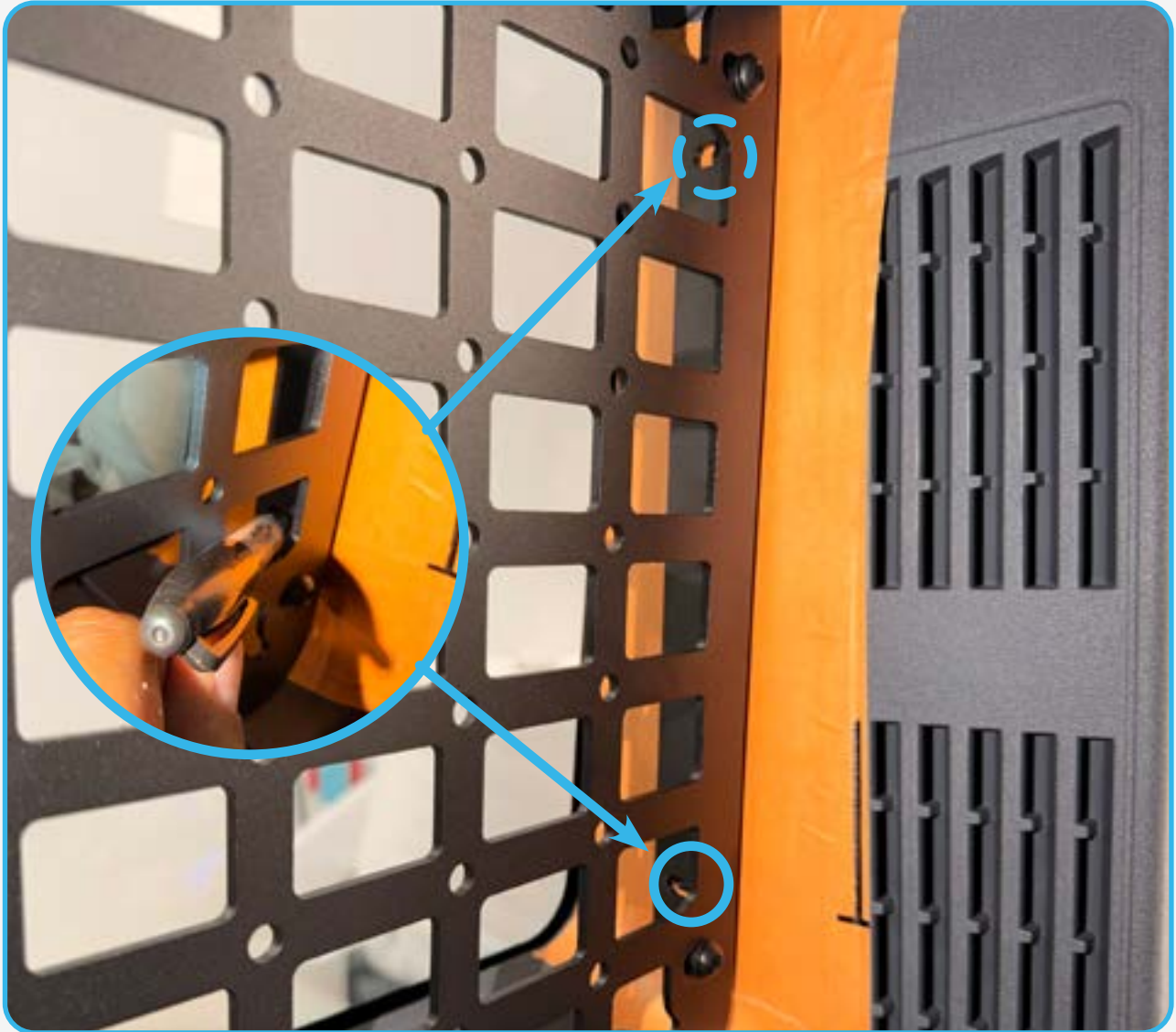

□ STEP 10

With the molle panel removed, remove the support bracket installed on **Step 6**.



□ STEP 11

Using a 25/64 drill bit, drill the holes marked in **step 9**. Once drilled install the provided (A2) 1/4-20 rivet nuts using a [rivet nut installation tool](#). You can now loosely install the Rear MSP support bracket using the provided (A1, B1) 1/4" hardware and a [5/32 allen](#).



□ STEP 12

Using a (T25 Torx) and a (Platic panel removal tool) remove the (2) cover panels as shown below.



STEP 13

With the plastic covers removed, drill a 9/16 hole on the points previously marked in **step 8**.



□ STEP 14

You can now reinstall the plastic covers.



□ STEP 15

Install the provided (B, B1, B2, C) M8 hardware into the upper mounting holes of the MOLLE panel as shown below.

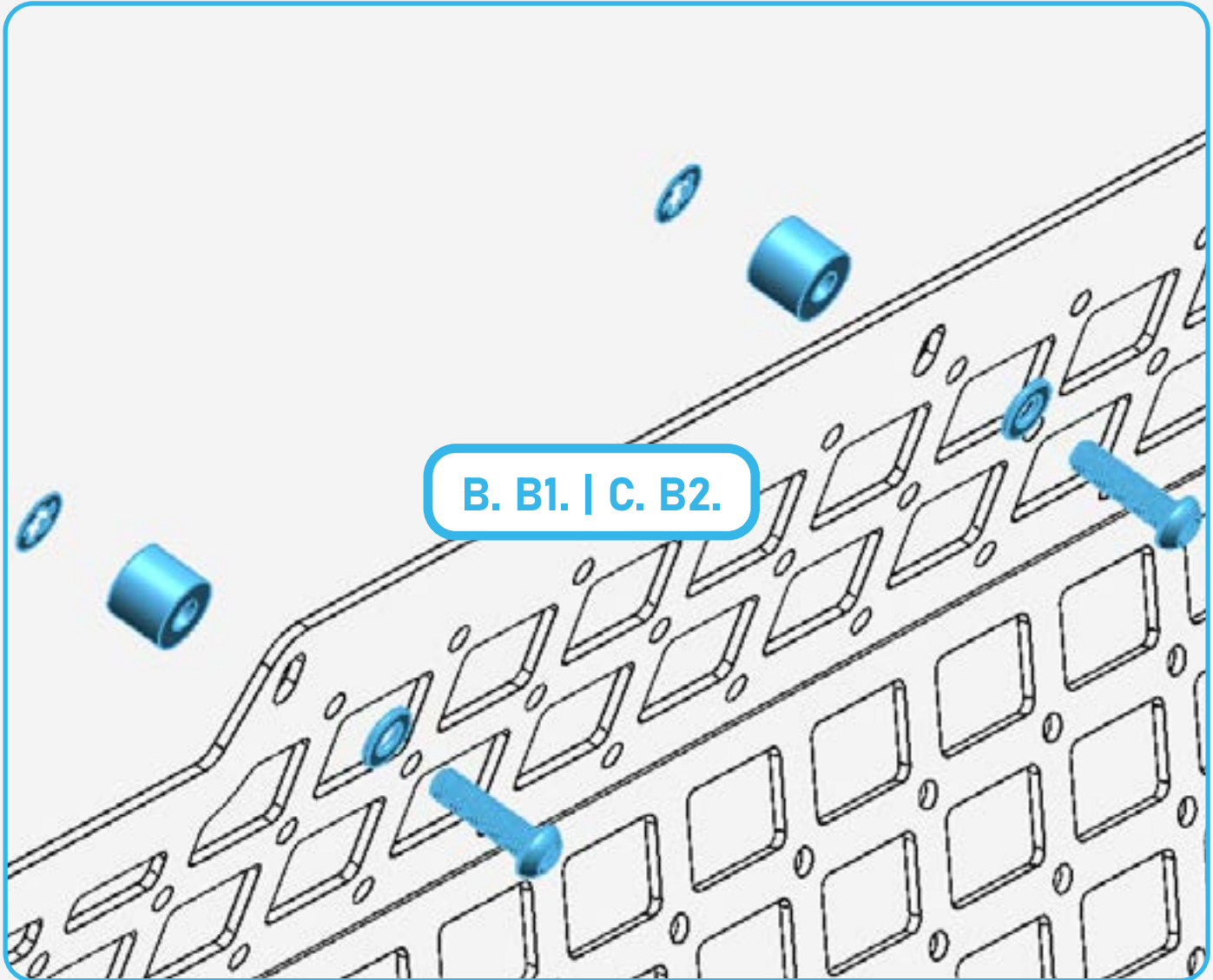

□ STEP 16

You can now install the upper half of the molle panel using a (3/16 allen) for the upper mounting, and a 5/32 allen and the provided (A, A3) 1/4" hardware for the bottom mounting and support bracket. (Apply blue loctite to all hardware)

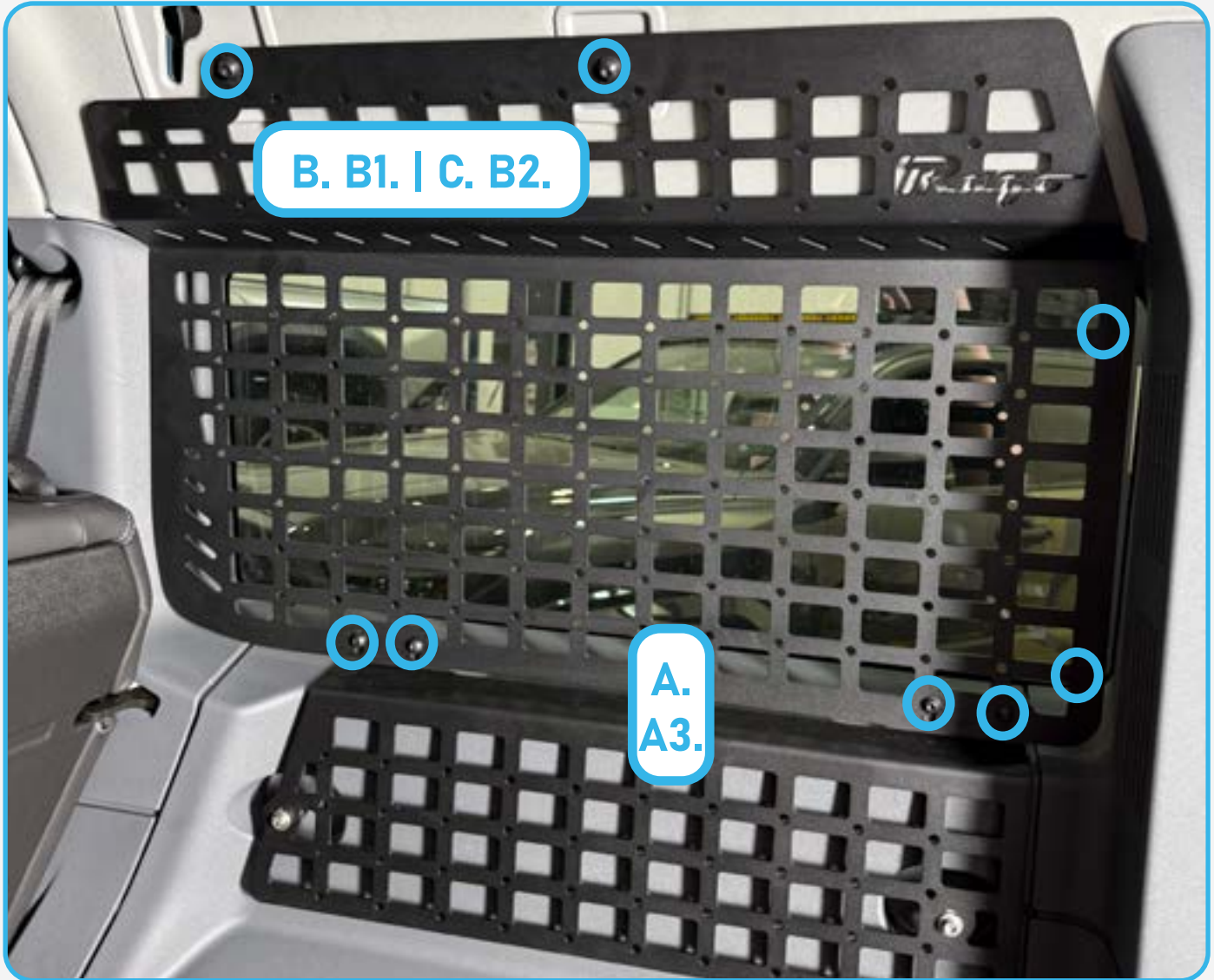

□ STEP 17

Stand back and enjoy your new RAGO Rear MSP.

Check and re-tighten all mounting bolts after 100 miles and periodically thereafter.

