

CENTER CONSOLE MOLLE STORAGE PANEL 2024/TOYOTA TUNDRA AC6702201NA

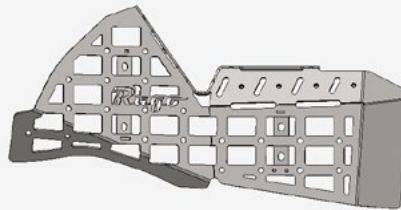
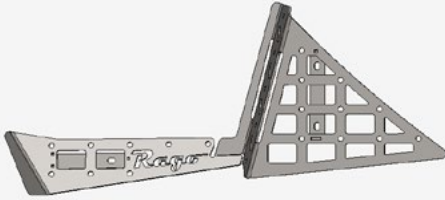

TOOLS REQUIRED

- 7/16 socket
- 9/16 wrench
- 5/32 Hex
- 15/64 Drill Bit
- Rivet Nut Tool
- Drill

SKILL LEVEL

- Easy

TIME REQUIRED

- Approximately 1 Hour

WARNINGS/CAUTIONS BEFORE STARTING INSTALLATION

-BEFORE YOU INSTALL THIS KIT-

Read and understand all instructions, warnings, cautions, & notes contained in this installation instruction guide. Consult your vehicle owner's manual for proper disconnection of electrical and lifting of vehicle if required for installation of this product.

This install may require some technical skills and knowledge of basic mechanical work. If you do not feel that you are capable of performing this install please take this product to a trained professional.

After reading this guide please contact us with any questions or concerns before installing product.

Customer Service: 830-896-7571
Rago Fabrication is not responsible for any bodily injury or harm to you or your vehicle as a result of an improper install.

Proper installation of this kit required knowledge of the factory recommended procedures for removal and installation of original equipment components.

We recommend that the factory shop manual and any special tools needed to service your vehicle be on hand during the installation. Installation of this kit without proper knowledge of the factory recommended procedures may affect the

performance of these components and the safety of the vehicle. Inspect all contents of this package to make sure product is not damaged and all installation hardware has been included. If parts are missing from kit, please be prepared to provide the following information:

1. Name of purchase location
2. Bar Code on side of box
3. Date above bar code
4. Date inside box cover

***ALWAYS WEAR EYE PROTECTION
WHEN OPERATING POWER TOOLS***

HARDWARE

A.

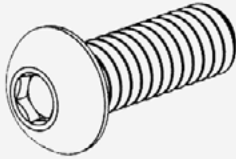

1/4-20 X 3/4" BUTTON HEAD

QTY: 7

A1.



1/4" FLAT WASHER

QTY: 7

B.

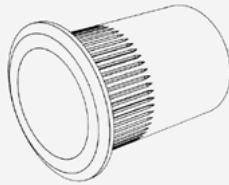

1/4-20 Rivet Nut

QTY: 7

Reference this page throughout the install



STEP 1

Place the molle in place and mark the holes as shown below. Repeat on other side.



STEP 2

Drill the marked holes from **step 1** by using a (15/64 drill bit). (Do not drill into the panel more than a 1/4" due to the components inside the center console)

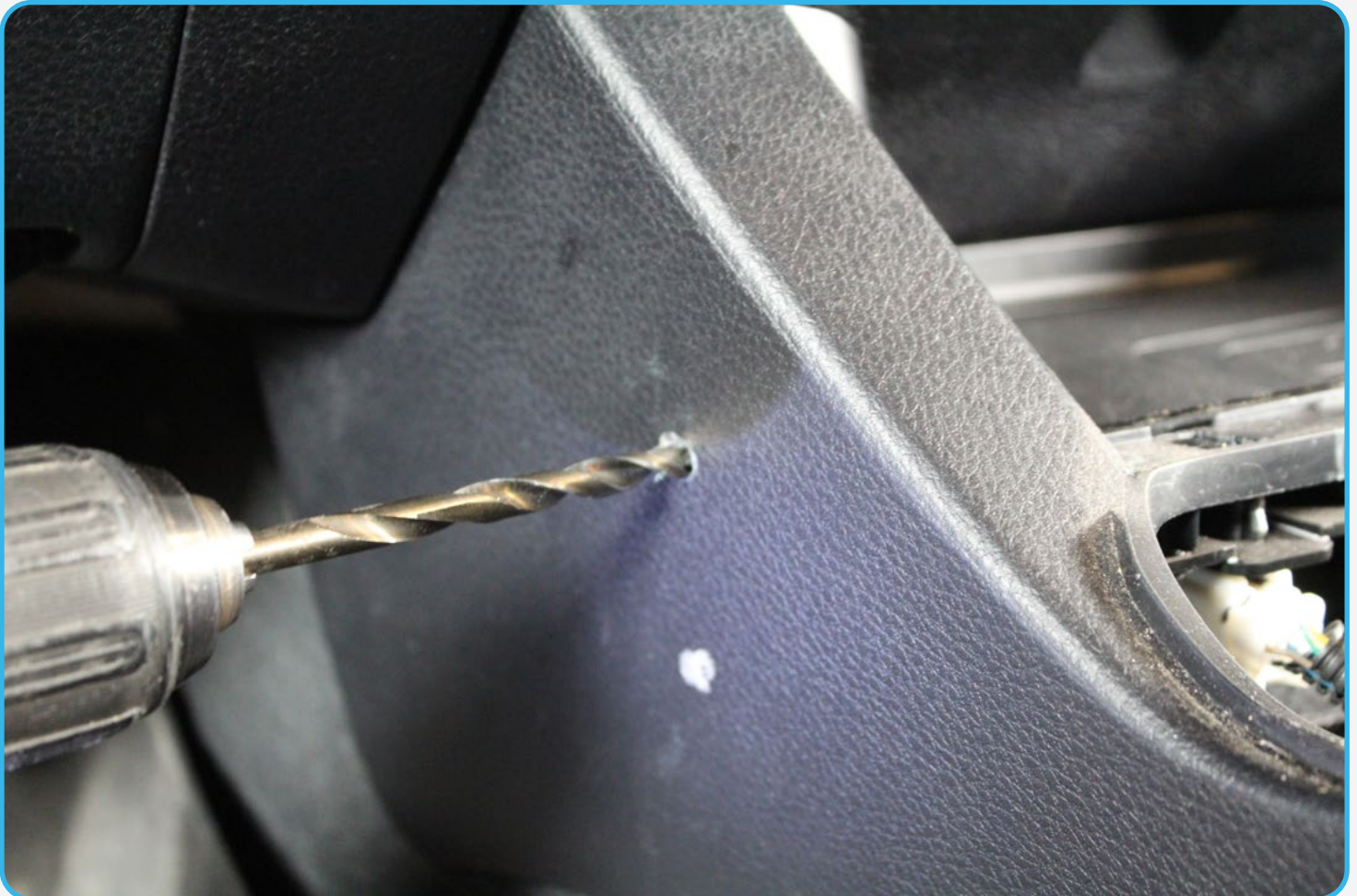

Pro Tip: Using a tape measure, mark the drill bit with a Sharpe or wrap tape around the bit to a 1/4"



□ STEP 3

If you do not have a rivet nut tool, use a 1/4-20 x 3/4 hex head bolt, a 1/4 washer, and a 3/8 nut to install the rivet nuts (B). Tighten using a (9/16 wrench) and a (7/16 socket) on a impact.

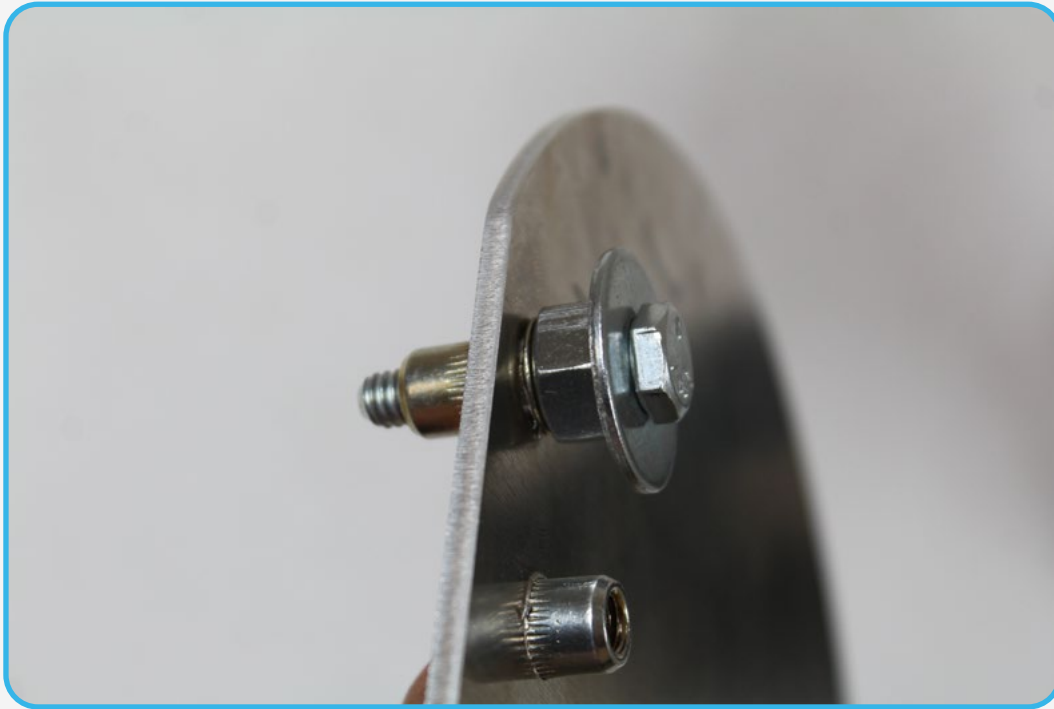

□ STEP 4

Ensure that all rivet nuts **(B)** are secure and do not spin before installing the molle panels.

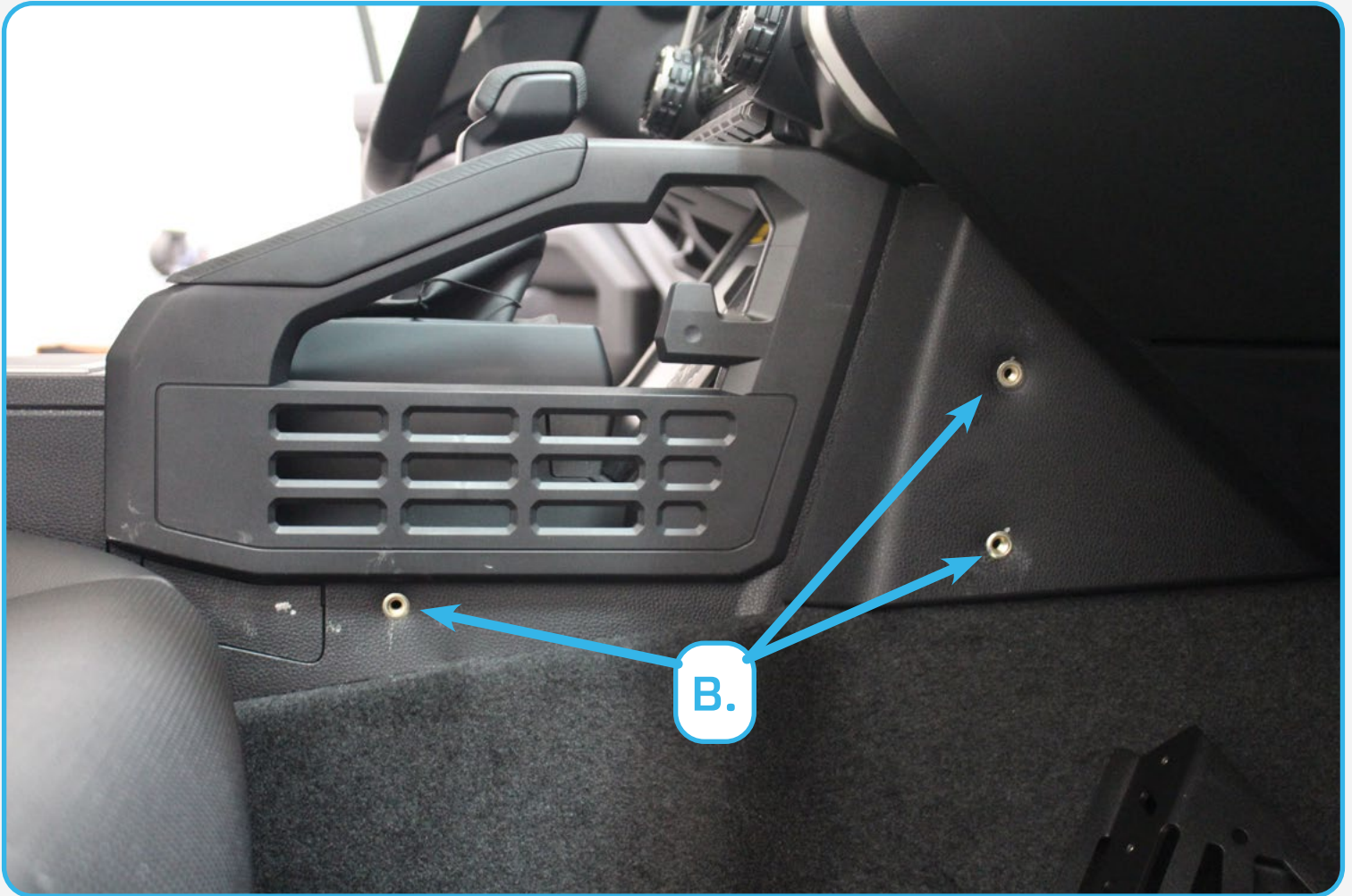

□ STEP 5

Install the molle panels on both sides with the provided **(A, A1)** hardware. Use a **(5/32 Hex)**.



STEP 6

Double check all hardware and fitment for security.

Enjoy your new Rago Center Console Molle Storage Panel.

