



INSTALLATION GUIDE

REAR MSP

2025-UP/TOYOTA 4RUNNER

AC7102801NA

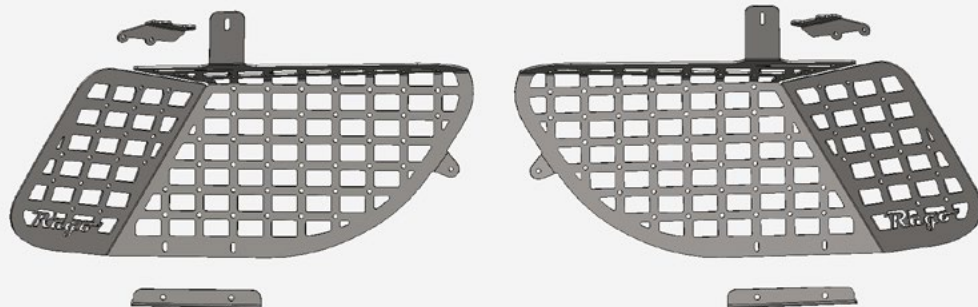

TOOLS REQUIRED

- 7/16 Sockets
- 7/16 Wrenches
- Pushpin Puller or Flathead Screwdriver
- Rivet Nut Hand Tool
- 5/32, 5mm Hex
- Marker
- Ruler
- Masking Tape
- Drill
- Step Drill Bit



SKILL LEVEL

- Easy



TIME REQUIRED

- Approximately 30 Minutes

⚠ WARNINGS/CAUTIONS BEFORE STARTING INSTALLATION ⚠

-BEFORE YOU INSTALL THIS KIT-

Read and understand all instructions, warnings, cautions, & notes contained in this installation instruction guide. Consult your vehicle owner's manual for proper disconnection of electrical and lifting of vehicle if required for installation of this product.

This install may require some technical skills and knowledge of basic mechanical work. If you do not feel that you are capable of performing this install please take this product to a trained professional.

After reading this guide please contact us with any questions or concerns before installing product.

Customer Service: 830-896-7571

Rago Fabrication is **not** responsible for any bodily injury or harm to you or your vehicle as a result of an improper install.

Proper installation of this kit required knowledge of the factory recommended procedures for removal and installation of original equipment components.

We recommend that the factory shop manual and any special tools needed to service your vehicle be on hand during the installation. Installation of this kit without proper knowledge of the factory recommended procedures may affect the

performance of these components and the safety of the vehicle.

Inspect all contents of this package to make sure product is not damaged and all installation hardware has been included. If parts are missing from kit, please be prepared to provide the following information:

1. Name of purchase location
2. Bar Code on side of box
3. Date above bar code
4. Date inside box cover

***ALWAYS WEAR EYE PROTECTION
WHEN OPERATING POWER TOOLS***

HARDWARE

A.



1/4-20 X 1/2" BUTTON HEAD BOLT

QTY: 12

A1.



1/4-20 X 3/4" BUTTON HEAD BOLT

QTY: 6

B.



M6 FLAT WASHER

QTY: 6

B1.



1/4" FLAT WASHER

QTY: 12

B2.



1/4-20" NYLON JAM NUT

QTY: 8

C.

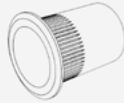

1/4-20" RIVET NUT

QTY: 6

D.

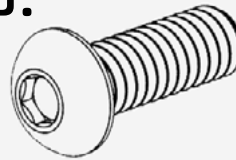

M8-1.25MM X 30MM BUTTON HEAD BOLT

QTY: 2

D1.



M8 WASHER

QTY: 2

E.

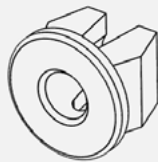

PLASTIC SNAP IN NUT

QTY: 2

F.

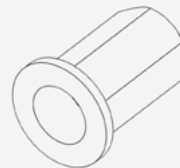

M8-1.25MM HEX RIVET NUT

QTY: 2

Reference this page throughout the install



□ STEP 1

Using a (flathead screwdriver), remove the cap and squeeze the metal tabs in together to remove the hook as shown below.

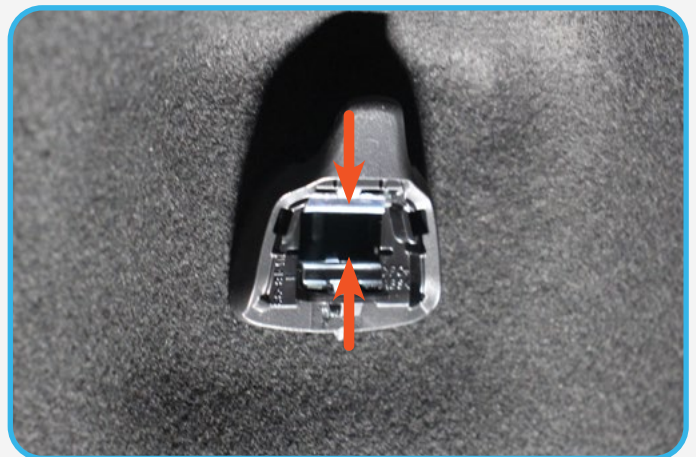

□ STEP 2

Tape the sections as shown below with masking tape. Next, using a (ruler) or your choice of measuring tools, use the edge of the cubby as a reference point as shown on the orange line. Next, measure a 1-1/8" over and mark a line. This will be used for locating the mounting bracket.



□ STEP 3

Place 2x (B2) 1/4 nuts for spacing the bracket away from the glass as shown below. Next, place the bracket against the nuts and the line you marked on **step 2**. Mark the slotted holes and set the bracket aside.

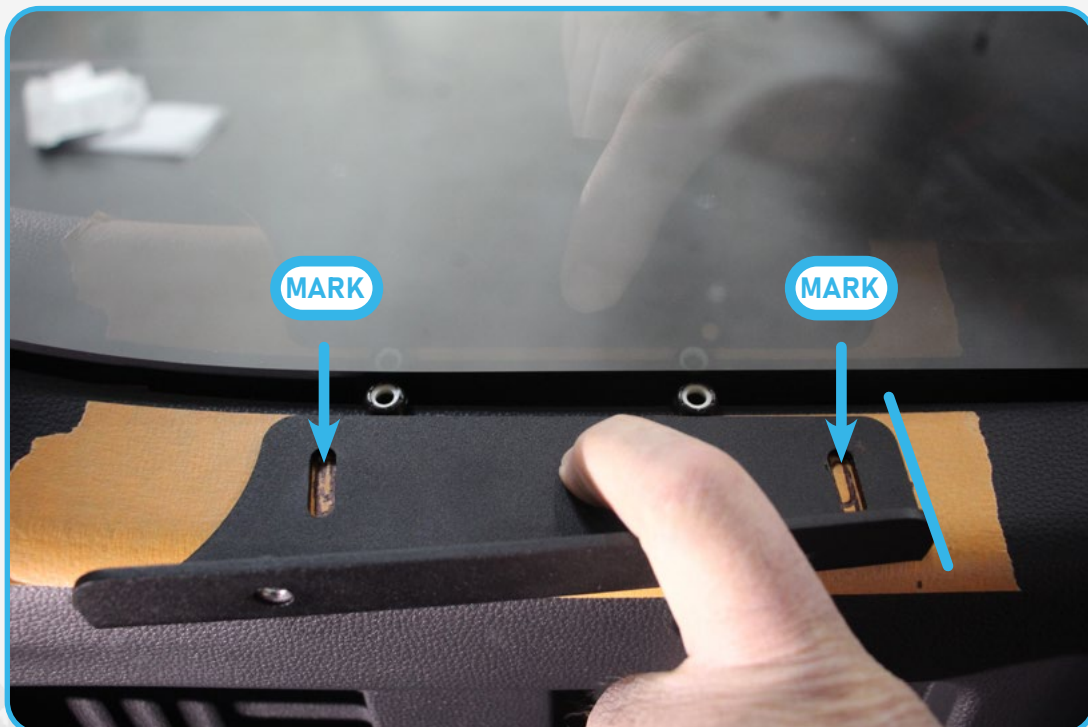

☐ STEP 4

Using a (Drill) and a (Step Drill Bit), drill a 7/16" hole in the center of the slot you marked on **step 3**.



□ STEP 5

Using a (rivet nut hand tool), install the provided (C) 1/4" rivet nuts in the holes drilled on **step 4**. **If you do not have a rivet nut tool**, use a 1/4-20 x 3/4 hex head bolt, a 1/4 washer, and a 3/8 nut (hardware not included) to install the rivet nuts (C). Tighten using a (9/16 wrench) and a (7/16 socket) on a impact.



□ STEP 6

Install the bracket shown below into the rivet nut installed on **step 5** with the provided (A1, B1) 1/4" hardware using a (5/32 allen). Leave loose enough for adjustments.



☐ STEP 7

(Standard) Using the provided (E) snap in nut, install into the mounting hole from **step 1**.

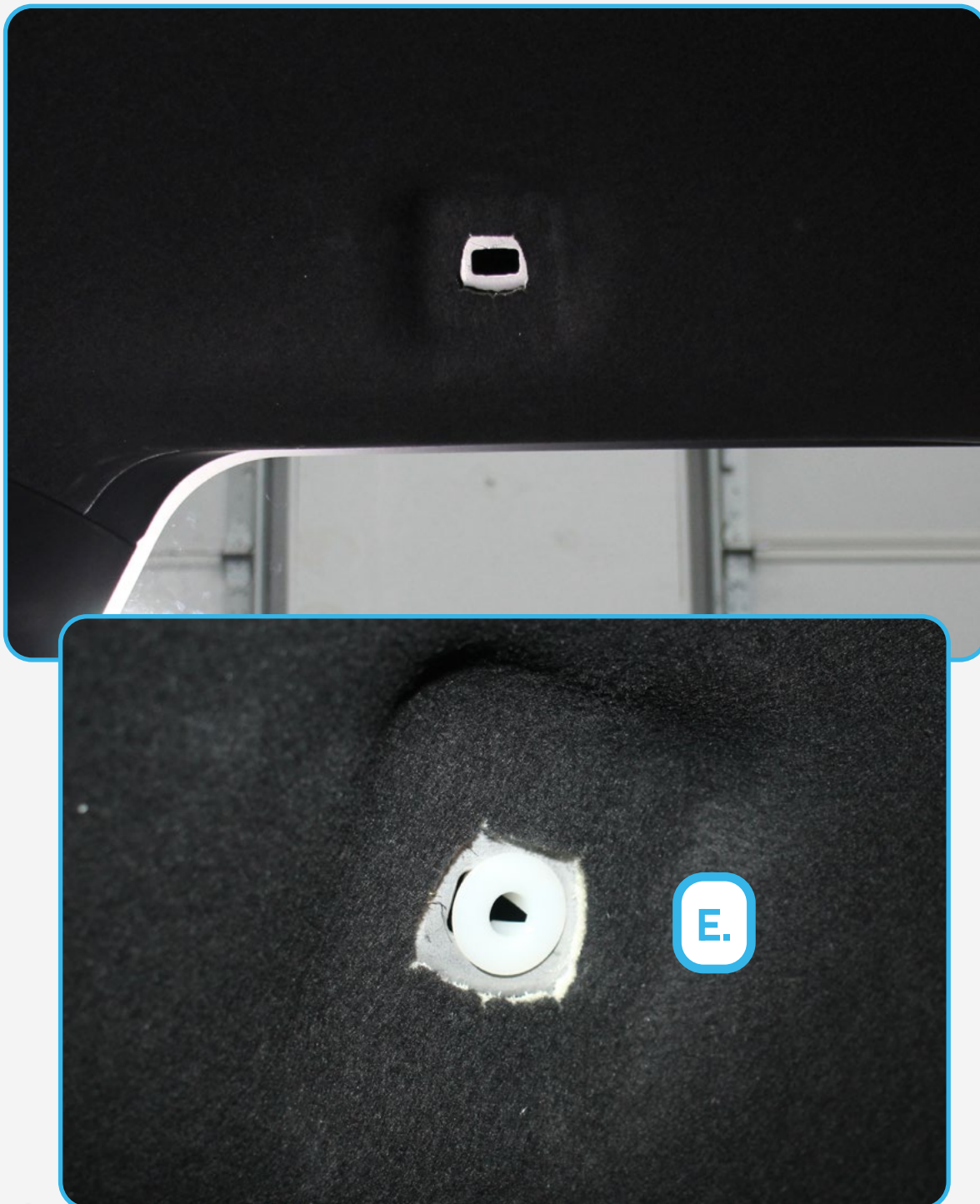

□ STEP 8

(Strength) Using the provided **(F)** M8 Hex Rivet Nut, install into the mounting hole from **step 1** using a **(rivet nut hand tool)**.

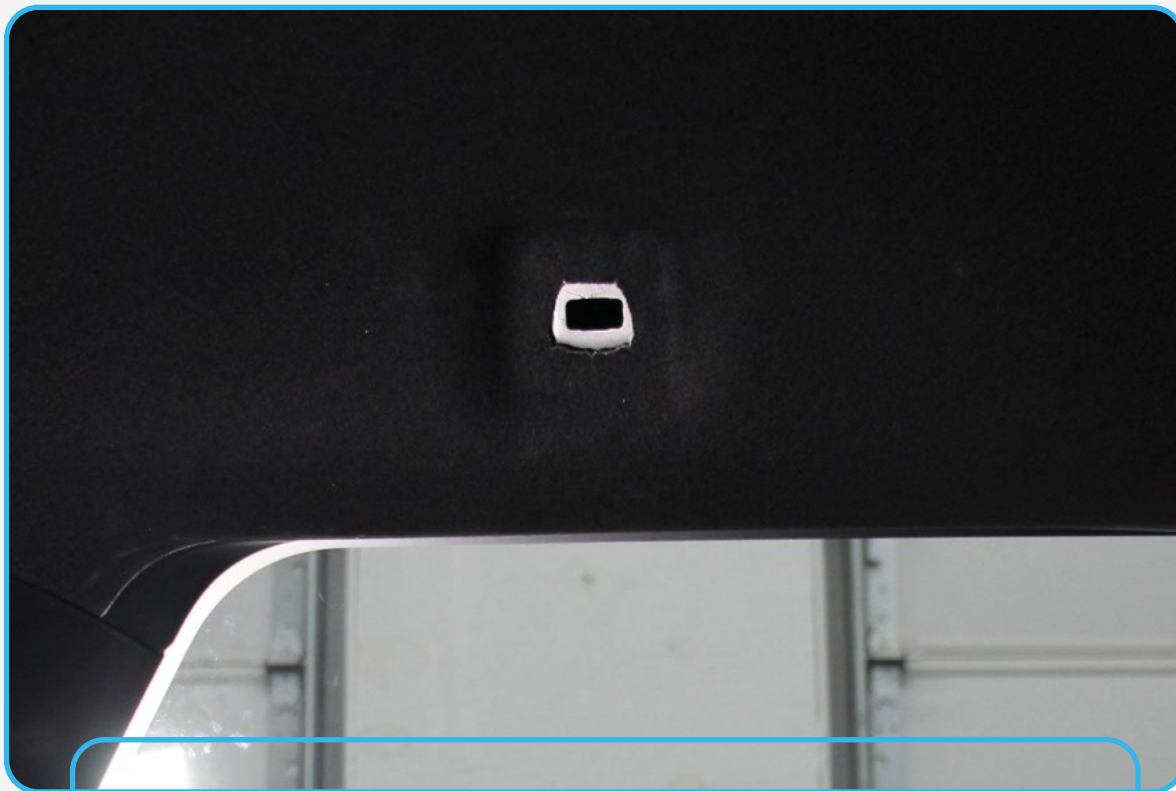
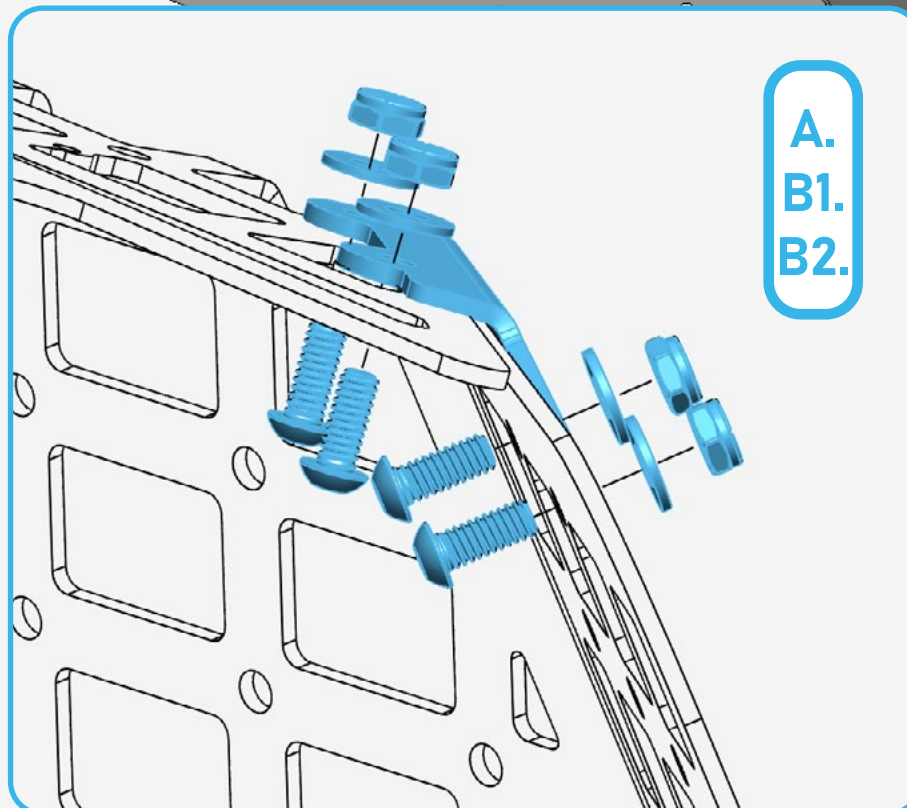
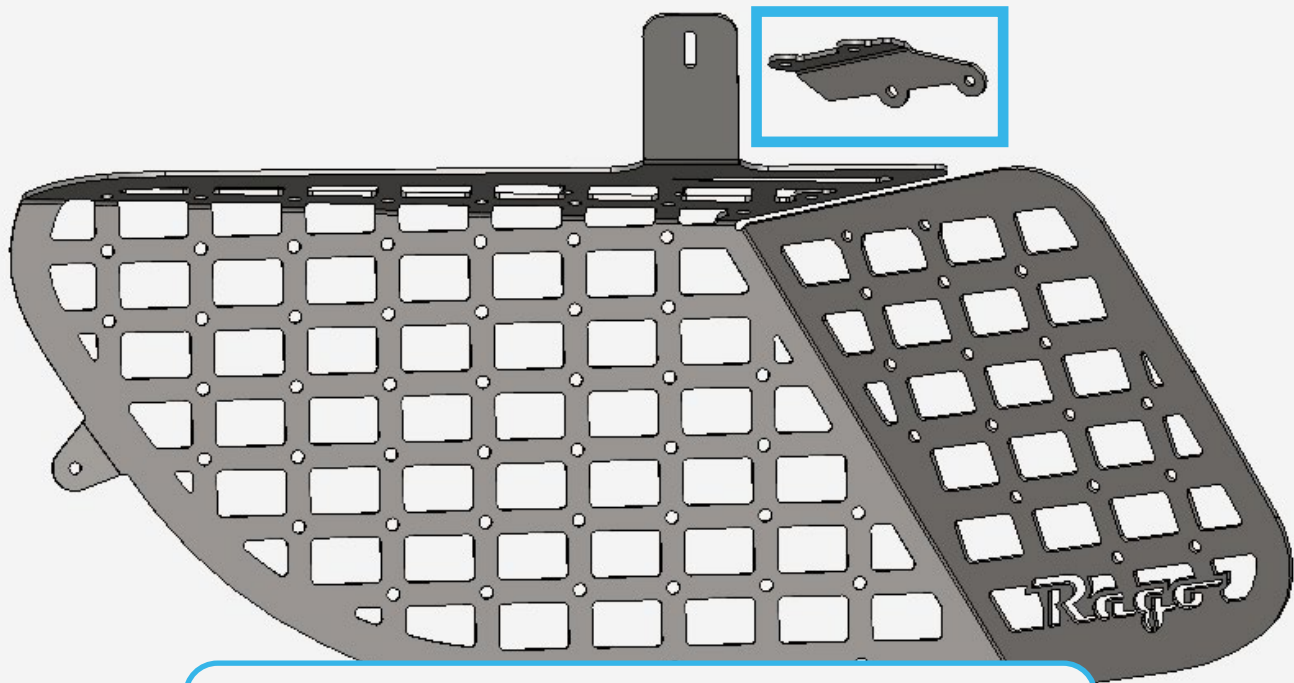

IMAGE COMING SOON



□ STEP 9

Install the support bracket to the MSP as shown below with the provided (A, B1, B2) 1/4" hardware using a (5/32 allen) and a (7/16 wrench).



□ STEP 10

Place the Rear MSP into position and install the provided (**D, D1**) M8 hardware into the snap in nut or rivet nut using a (**HW5 allen**). Leave loose enough for adjustments.

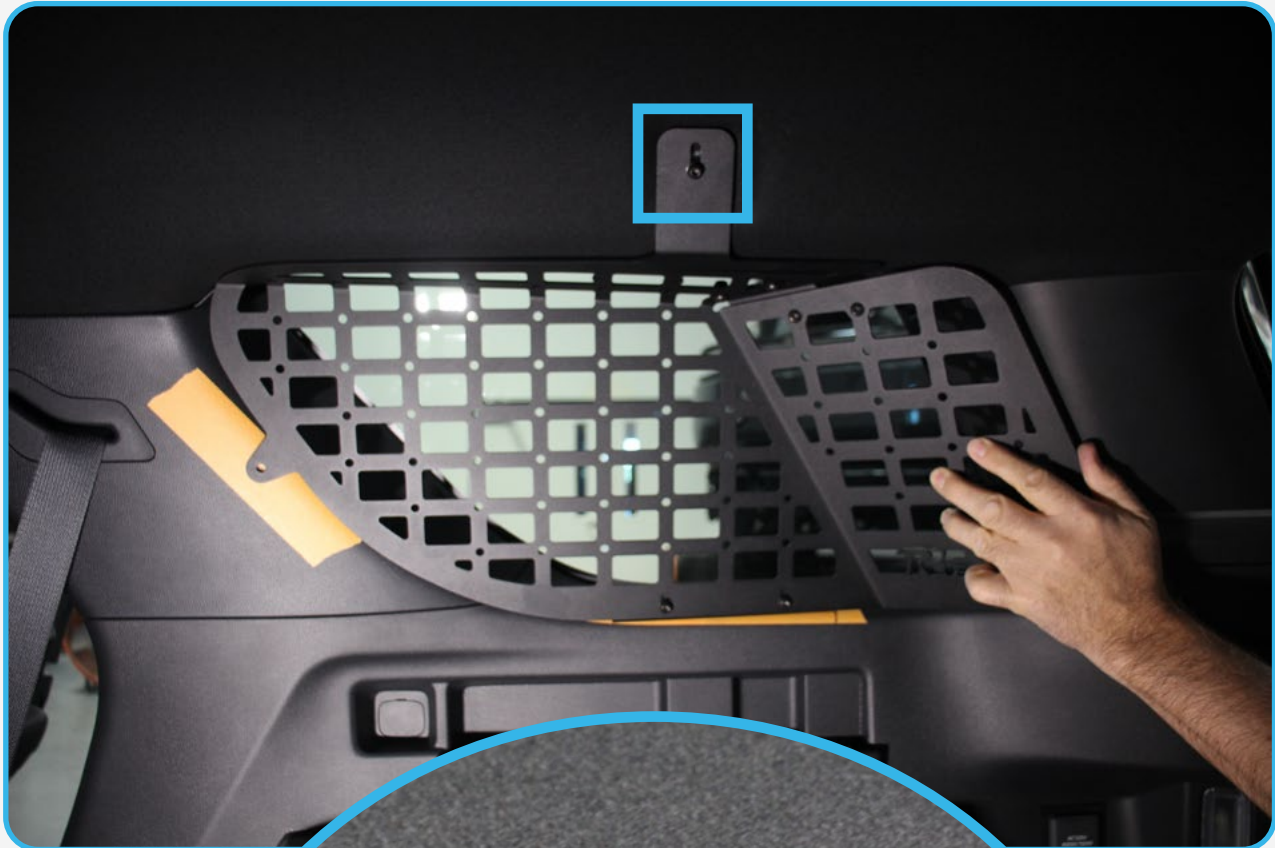

□ STEP 11

Install the provided (A, B) 1/4 hardware with washer into the bracket installed on **step 6** using a (5/32 allen). Leave loose enough for adjustments.



□ STEP 12

Position the MSP level with the top and side as highlighted below or in the desired position you prefer. Next, mark the forward facing hole and remove the MSP and set aside.



□ STEP 13

Using a (Drill) and a (Step Drill Bit), drill a 7/16" hole in the center of the slot you marked on **step 11**. Next, Using a (rivet nut hand tool) or the method used on **step 5** Install the provided (C) 1/4" rivet nut.



□ STEP 14

Re position the MSP and repeat **steps 10 & 11**. Next install the provided **(A, B)** 1/4" hardware using a **(5/32 allen)** into the rivet nut installed on **step 13**.

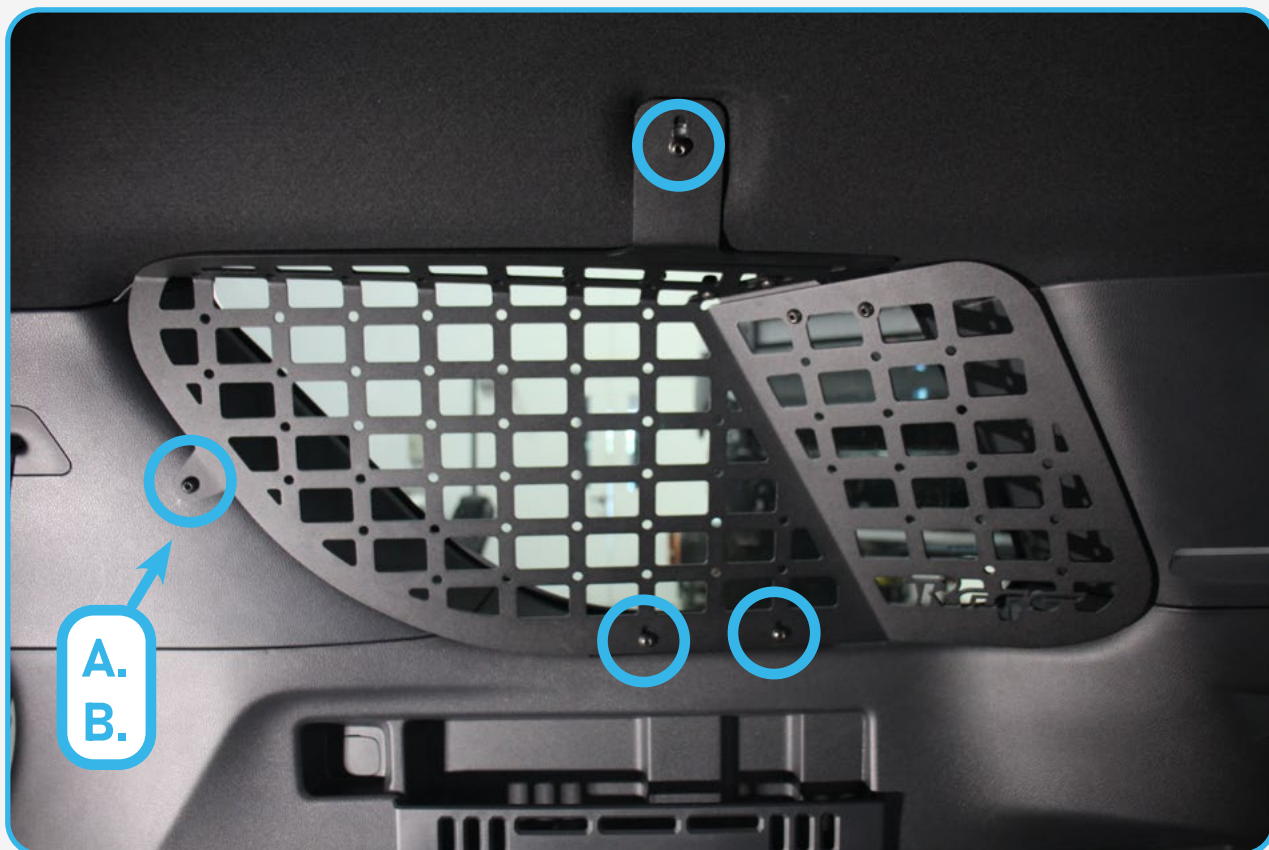

☐ STEP 15

Stand back and enjoy your new RAGO Rear MSP.

Check and re-tighten all mounting bolts after 100 miles and periodically thereafter.

