

## CROSSMEMBERS FOR FACTORY ROOF RAILS

### 2025-UP/TOYOTA 4RUNNER

AC7109501NA

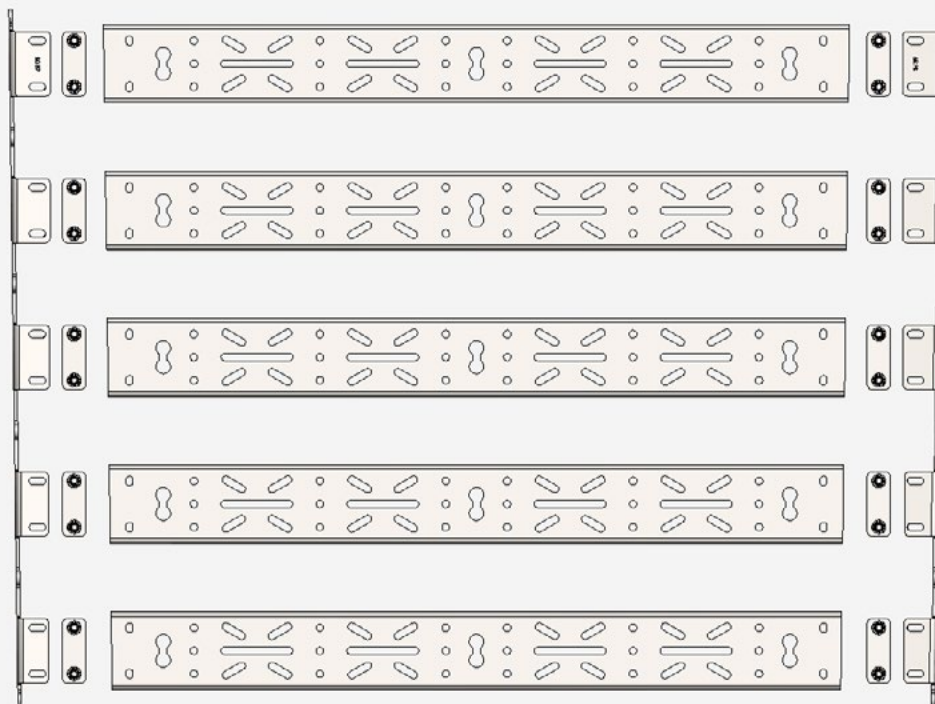

### TOOLS REQUIRED

- 10mm, 12mm sockets
- 5/32, 7/32 Hex
- Plastic Pry Tool
- Rivet Nut Hand Tool
- 25/64 Drill Bit
- Drill



### SKILL LEVEL

- Easy



### TIME REQUIRED

- Approximately 30 Minutes

## ⚠ WARNINGS/CAUTIONS BEFORE STARTING INSTALLATION ⚠

#### -BEFORE YOU INSTALL THIS KIT-

**Read and understand all instructions,** warnings, cautions, & notes contained in this installation instruction guide. Consult your vehicle owner's manual for proper disconnection of electrical and lifting of vehicle if required for installation of this product.

This install may require some technical skills and knowledge of basic mechanical work. If you do not feel that you are capable of performing this install please take this product to a trained professional.

After reading this guide please contact us with any questions or concerns before installing product.

Customer Service: 830-896-7571

Rago Fabrication is **not** responsible for any bodily injury or harm to you or your vehicle as a result of an improper install.

Proper installation of this kit required knowledge of the factory recommended procedures for removal and installation of original equipment components.

We recommend that the factory shop manual and any special tools needed to service your vehicle be on hand during the installation. Installation of this kit without proper knowledge of the factory recommended procedures may affect the

performance of these components and the safety of the vehicle.

Inspect all contents of this package to make sure product is not damaged and all installation hardware has been included. If parts are missing from kit, please be prepared to provide the following information:

1. Name of purchase location
2. Bar Code on side of box
3. Date above bar code
4. Date inside box cover

**\*ALWAYS WEAR EYE PROTECTION WHEN OPERATING POWER TOOLS\***

## **HARDWARE**

**A.**



1/4-20 X 1" BUTTON HEAD

**QTY: 12**

**A1.**



1/4" FLAT WASHER

**QTY: 12**

**B.**

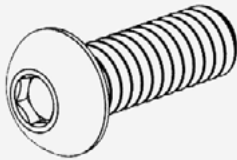

3/8-16 X 3/4" BUTTON HEAD BOLT

**QTY: 20**

**B1.**



3/8" FLAT WASHER

**QTY: 20**

**C.**

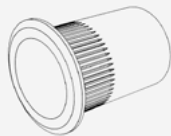

1/4-20" RIVET NUT

**QTY: 12**

**D.**

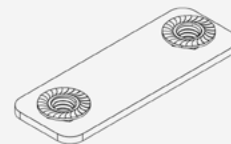

SPL0913

**QTY: 10**

Reference this page throughout the install



## □ STEP 1

Remove the OEM roof rack caps by using a pry tool of your choice. Reference **page 2** for removal instruction. Insert the plastic pry tool into the plastic shown below to pry the clips away from the mount. **(Use a plastic pry tool so you do not damage the paint)**

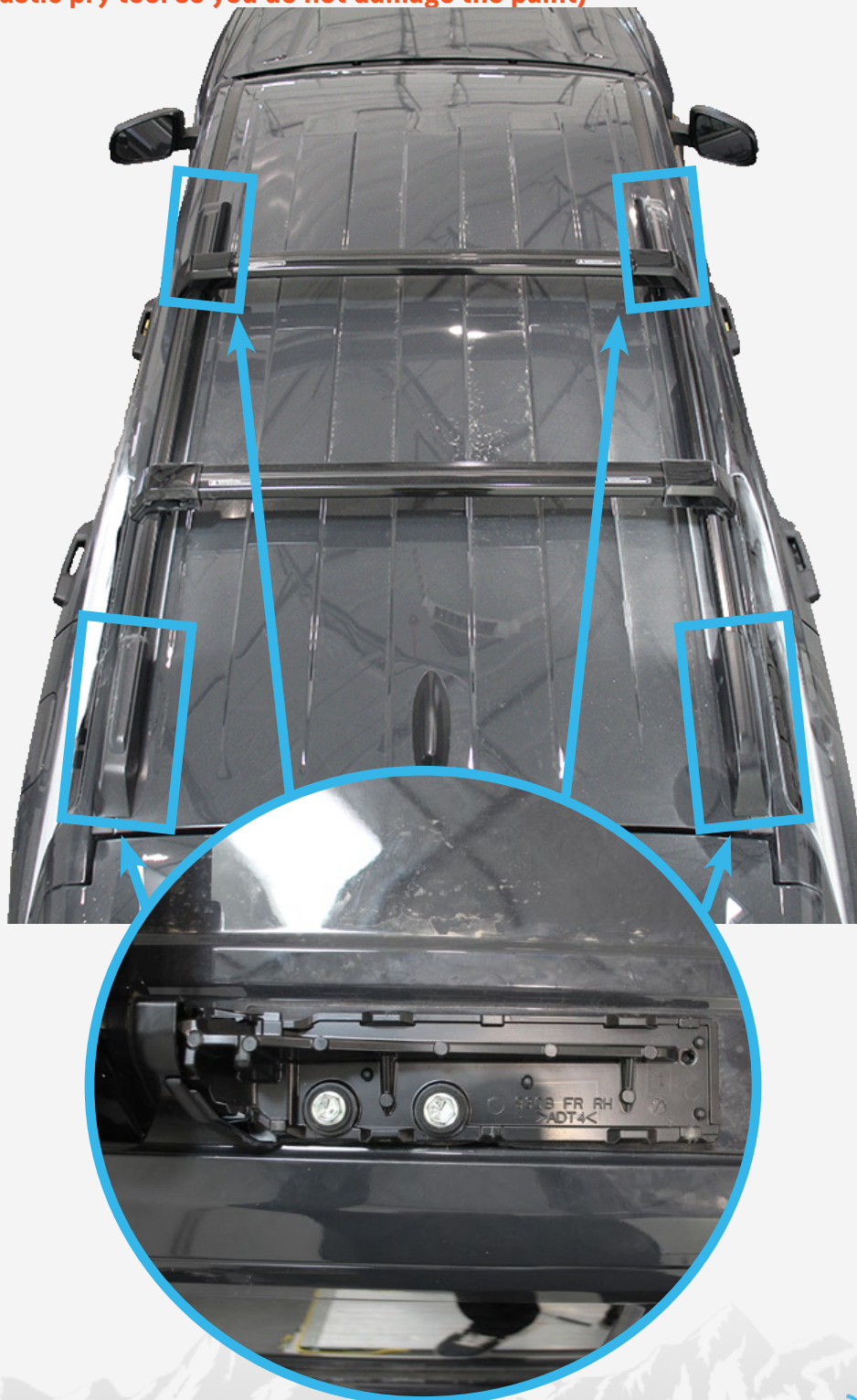





**STEP 2**

Using a (12mm socket) remove the mounting bolts. You can now remove the roof rack.





## □ STEP 3

Remove the caps located on the OEM cross members using a (plastic pry tool) as shown below.



## □ STEP 4

Using a (10mm socket), fully loosen the cross member bolt.

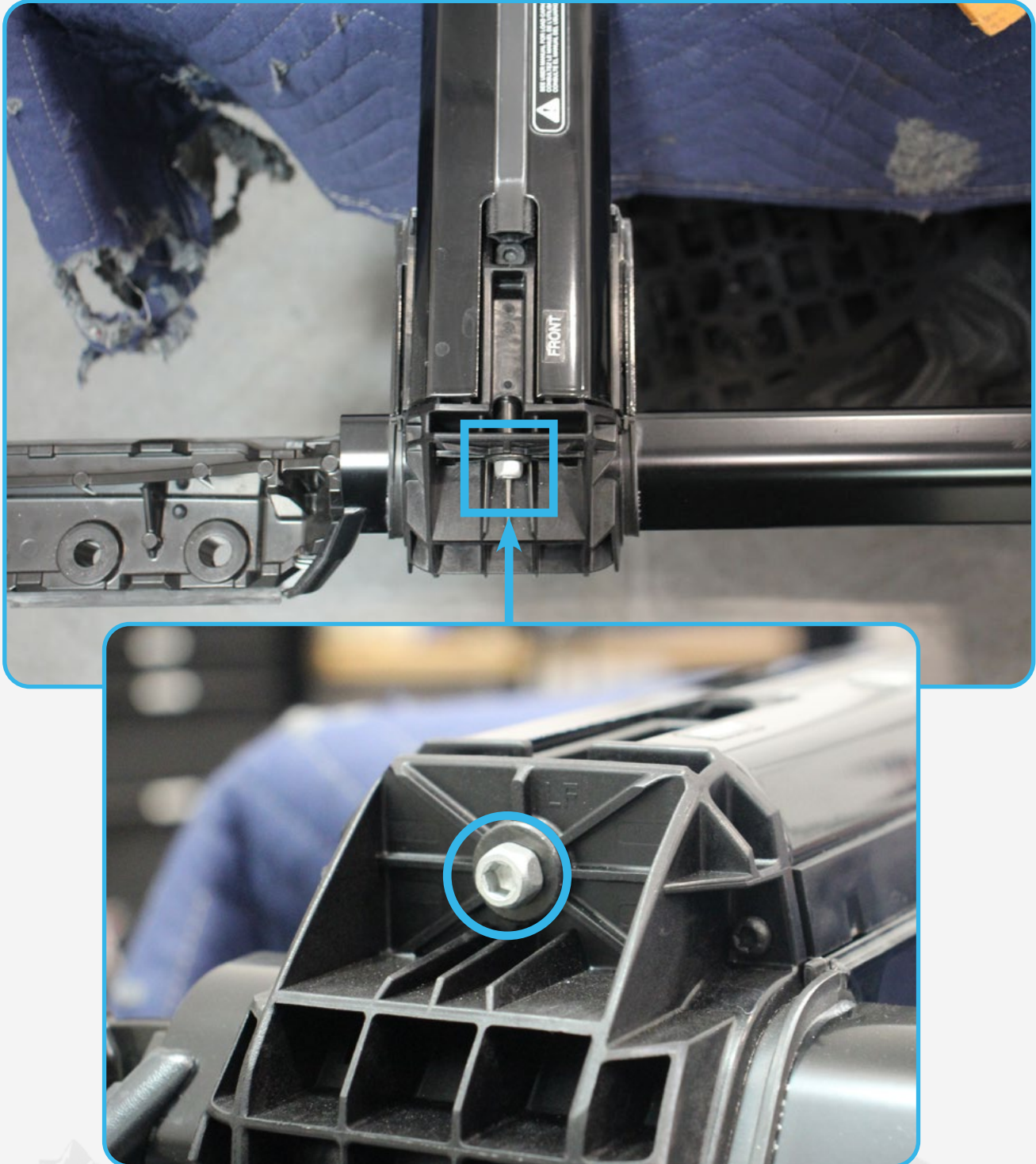



## ☐ STEP 5

Slid the clamp outwards and remove the cross members.

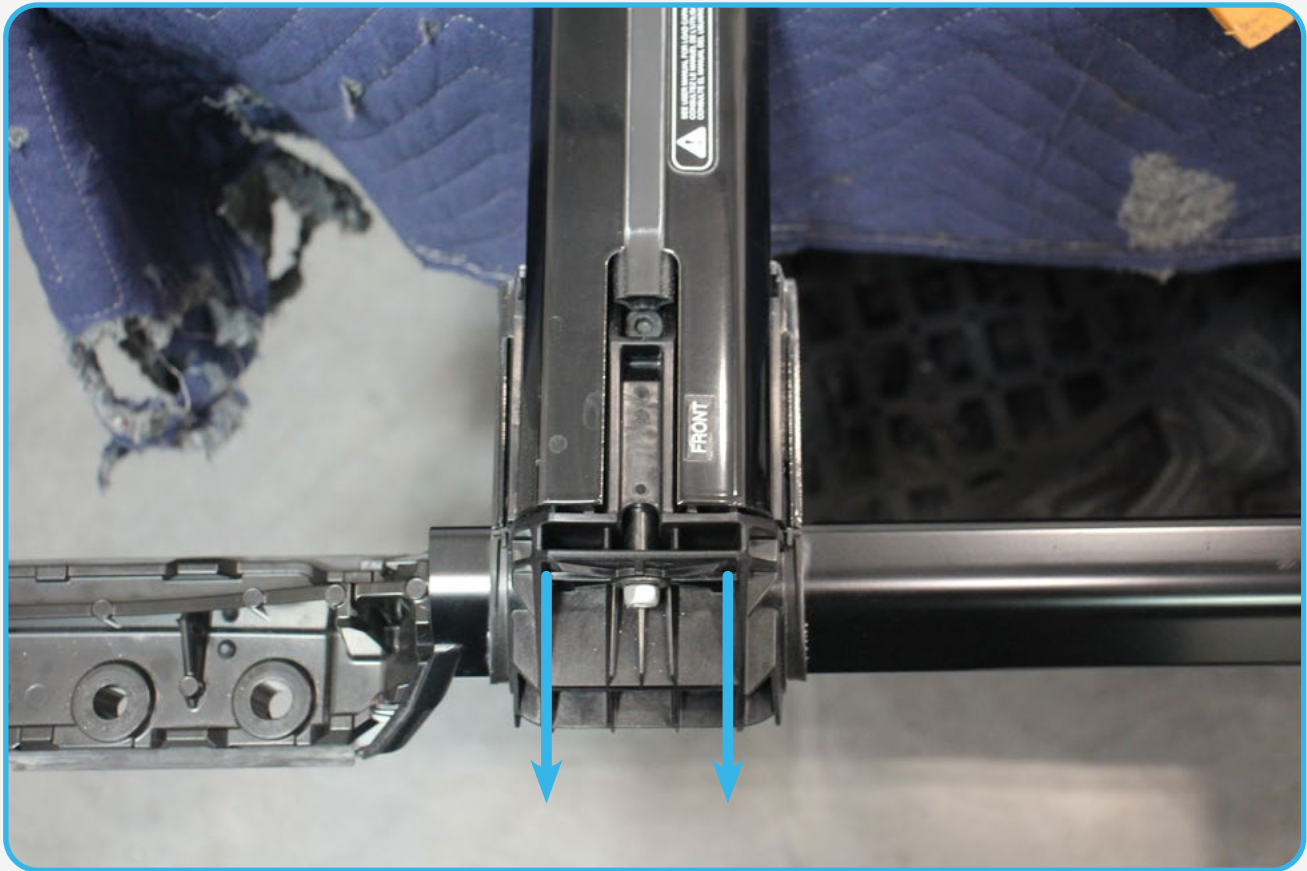



## STEP 6

Shown below is the layout to follow for assembly. Ensure that the cross members are laid out in order from 1-5. (Each cross member has a number etched). Number 1 is the front of the roof rack, and 5 is the rear. (Ensure to have each logo oriented the way shown below).

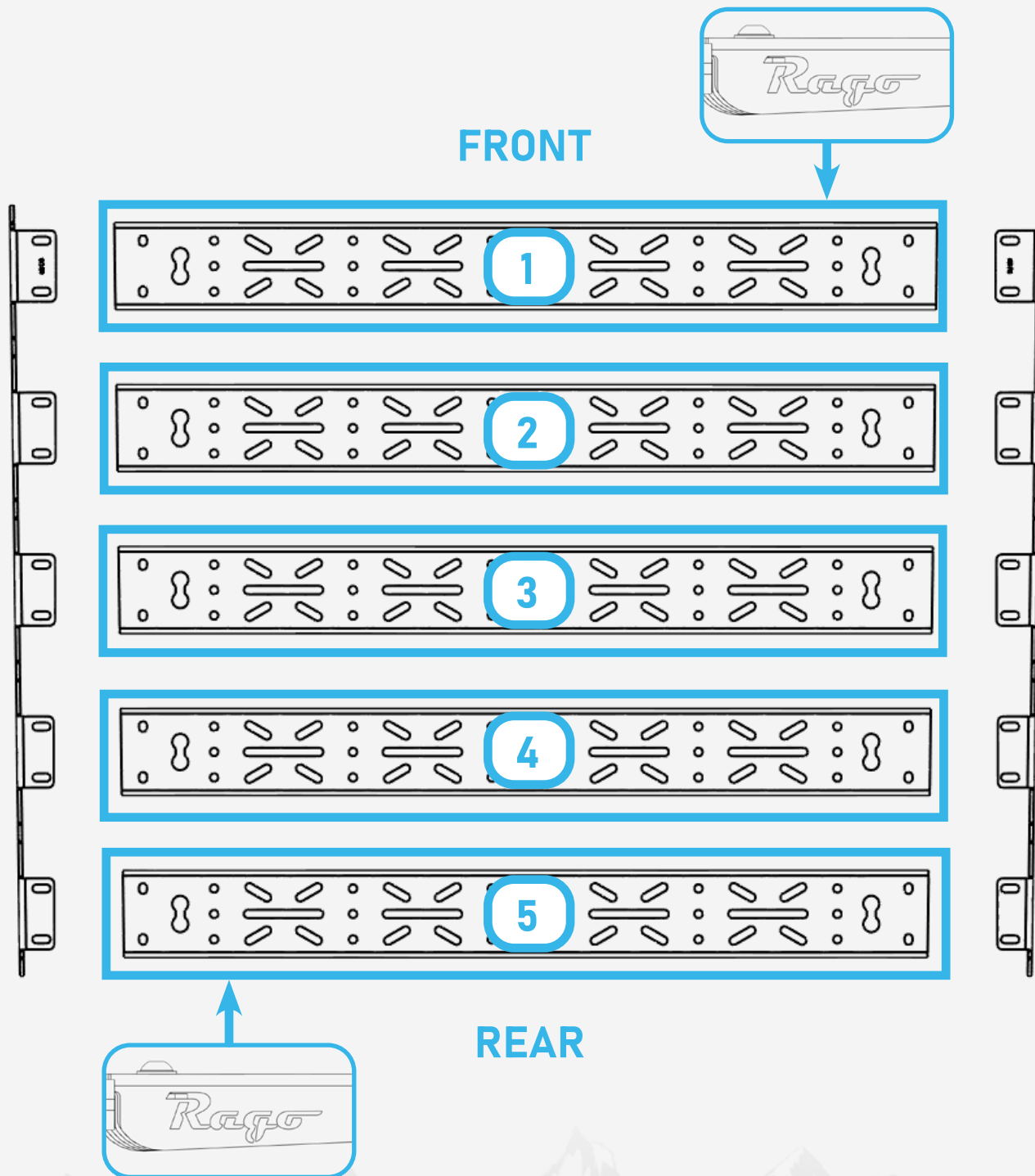

## STEP 7

Shown below is the mounting brackets. They are ID for DS (Driver Side) and PS (Passenger Side). Ensure that section that has the ID is installed in the orientation shown below.

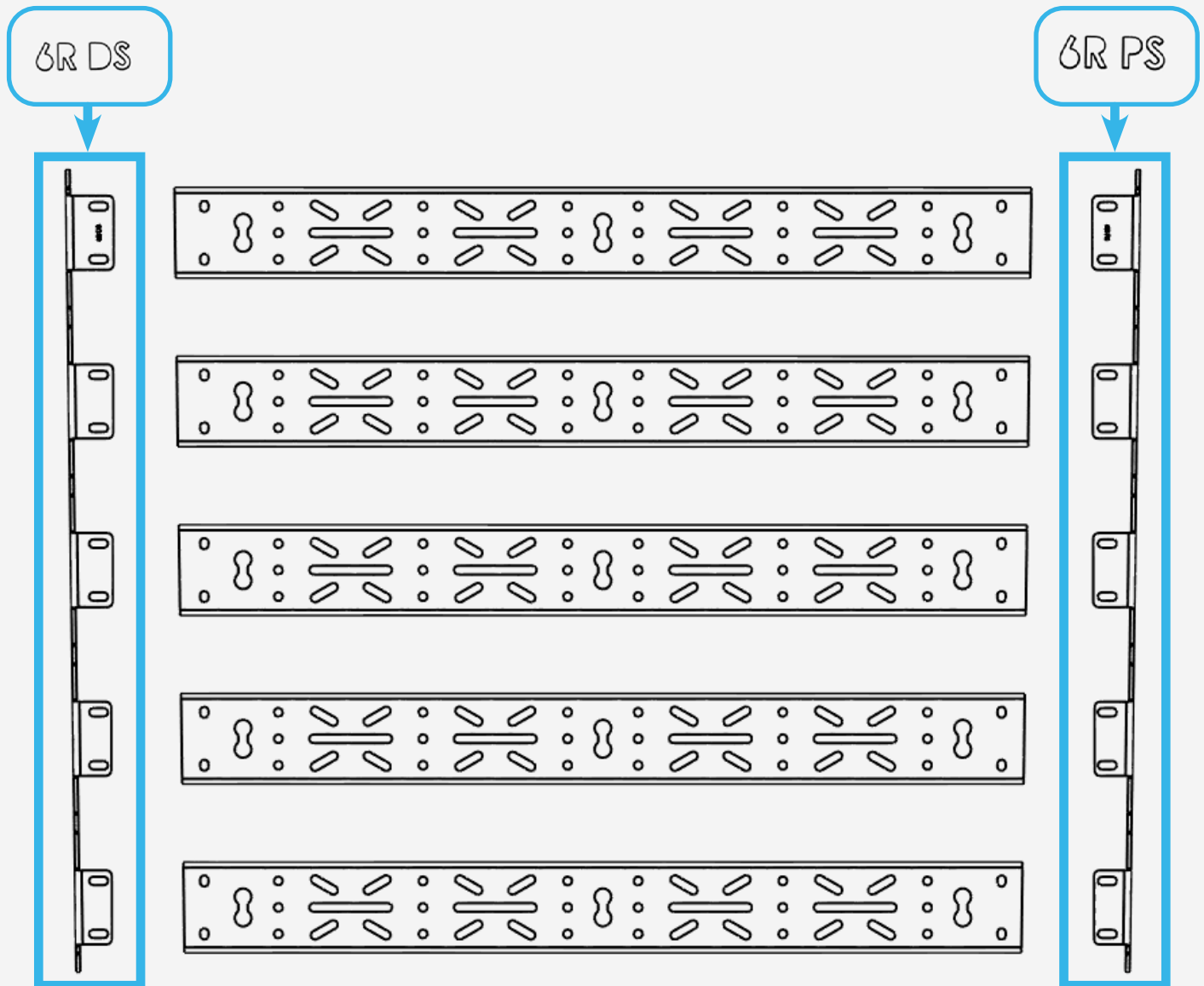

## □ STEP 8

With the provided (D) nut plates, install the cross members with the provided (B, B1) 3/8 hardware using a (7/32 allen). **(Leave loose for adjustments)**

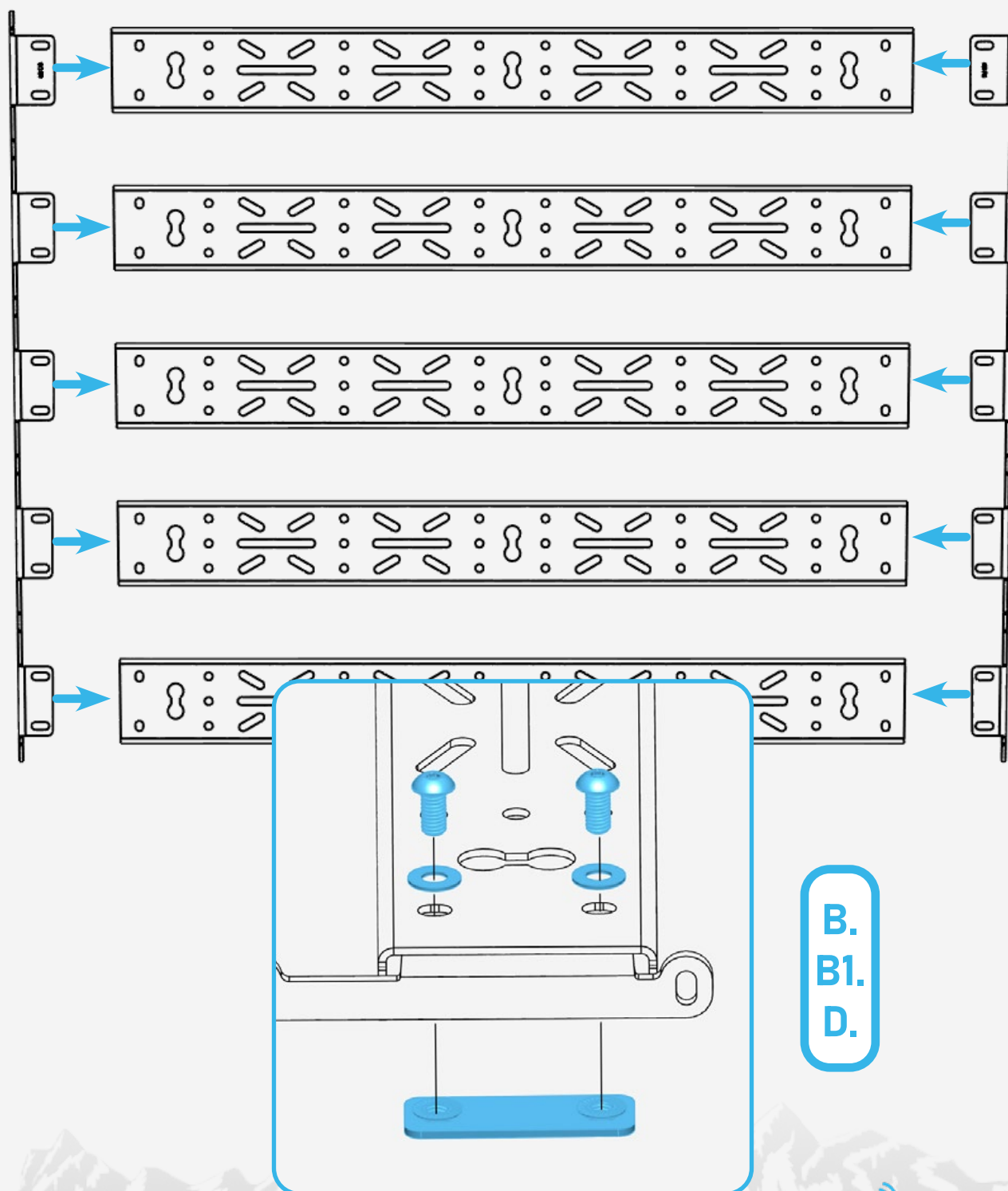

B.  
B1.  
D.





## □ STEP 9

With a helping hand, hold the roof rails to the cross members, ensure that the front section of the cross members is 1" away from the edge as shown below.

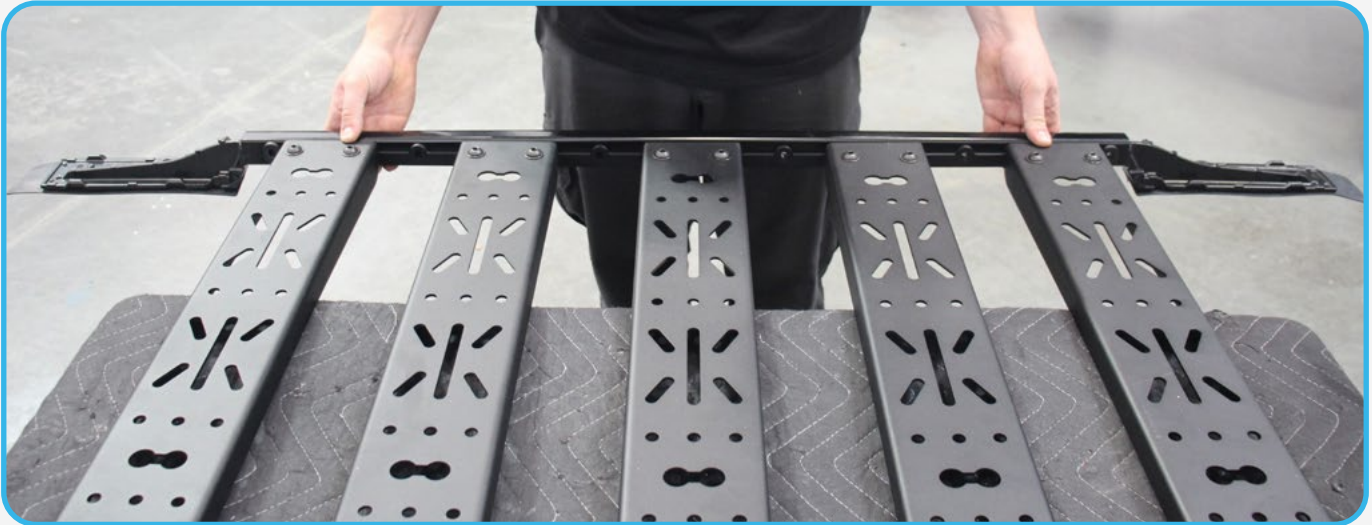

## □ STEP 10

Next ensure that both front and rear cross members are flush with the top of the roof rail as shown below and mark the 6x holes on each side.

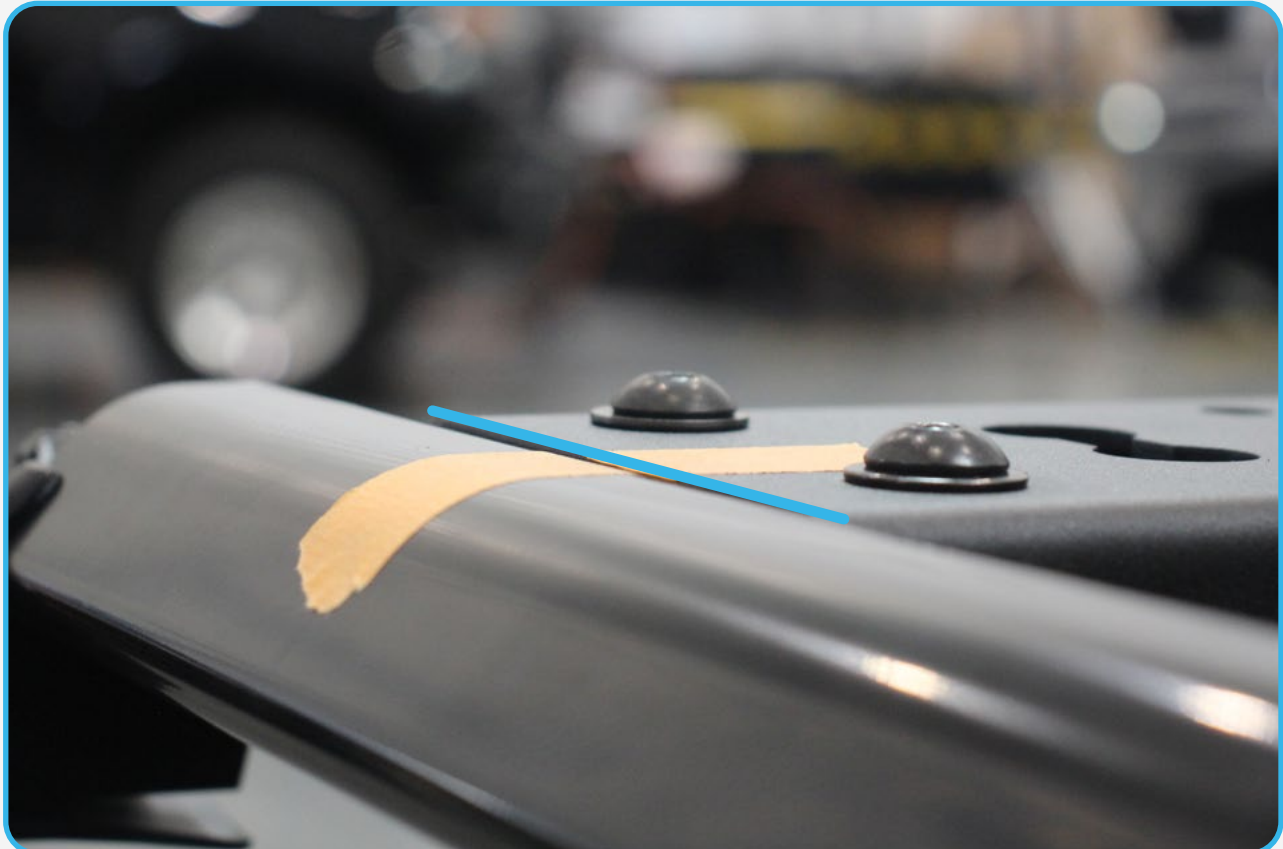
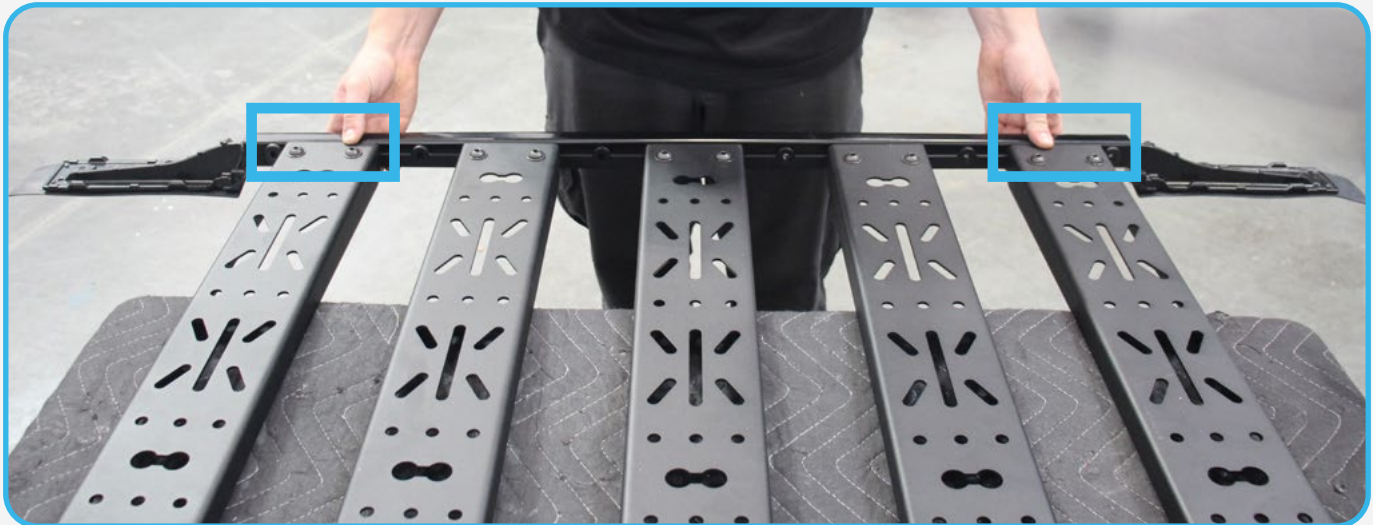



## □ STEP 11

Using a (25/64 drill bit) drill the marked holes and install the provided (C) rivet nuts using a (rivet nut hand tool).

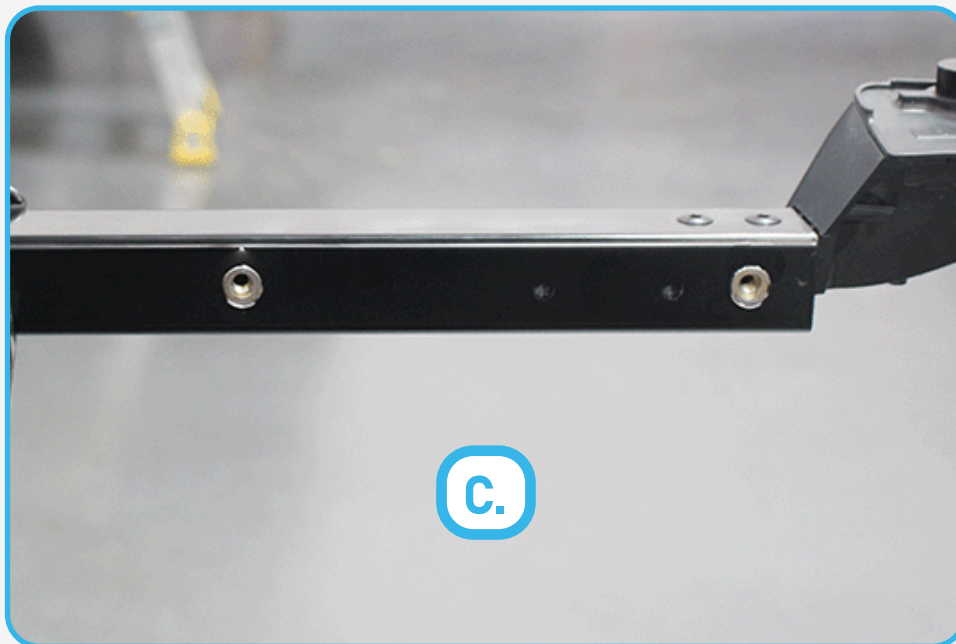



## □ STEP 12

Re-install the roof rails using the hardware removed from **step 2**. **(Do not fully tighten)**



## □ STEP 13

With a helping hand, **correctly** install the cross members into the rivet nuts installed on **step 11** with number 1 in the front and number 5 in the rear with the provided **(A, A1)** 1/4 hardware using a **(5/32 allen)**.

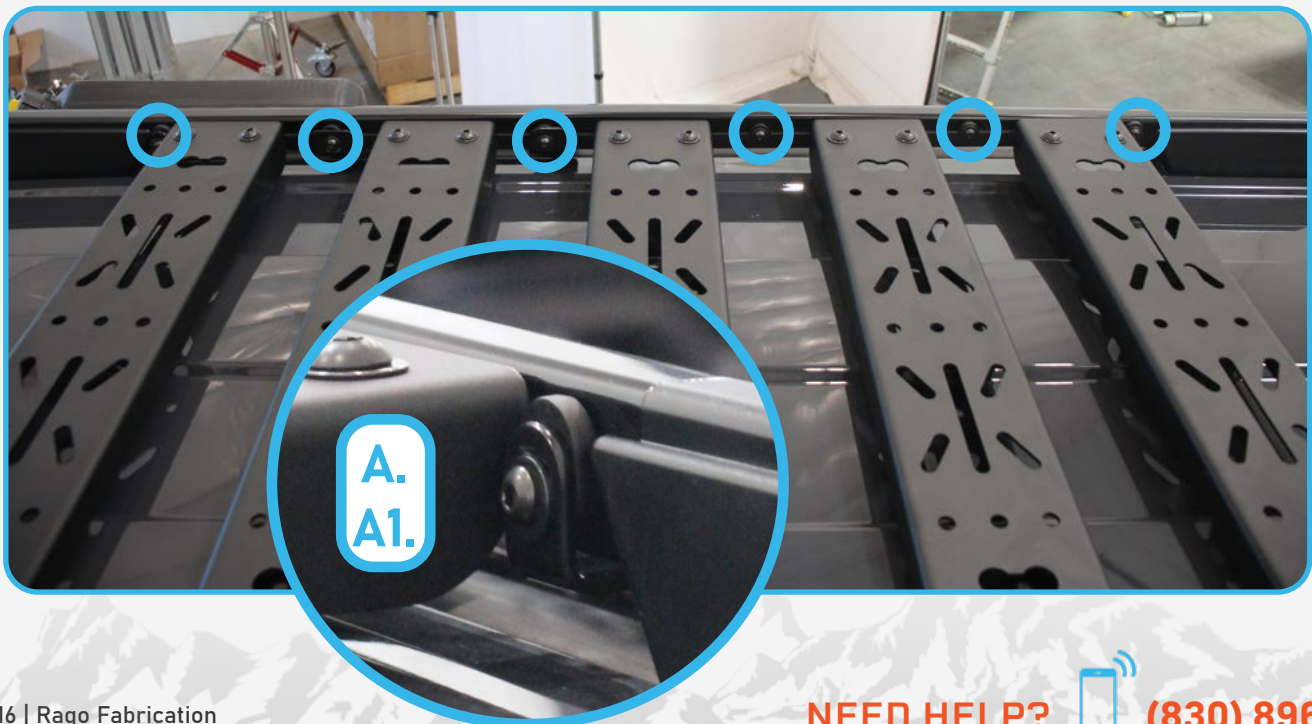
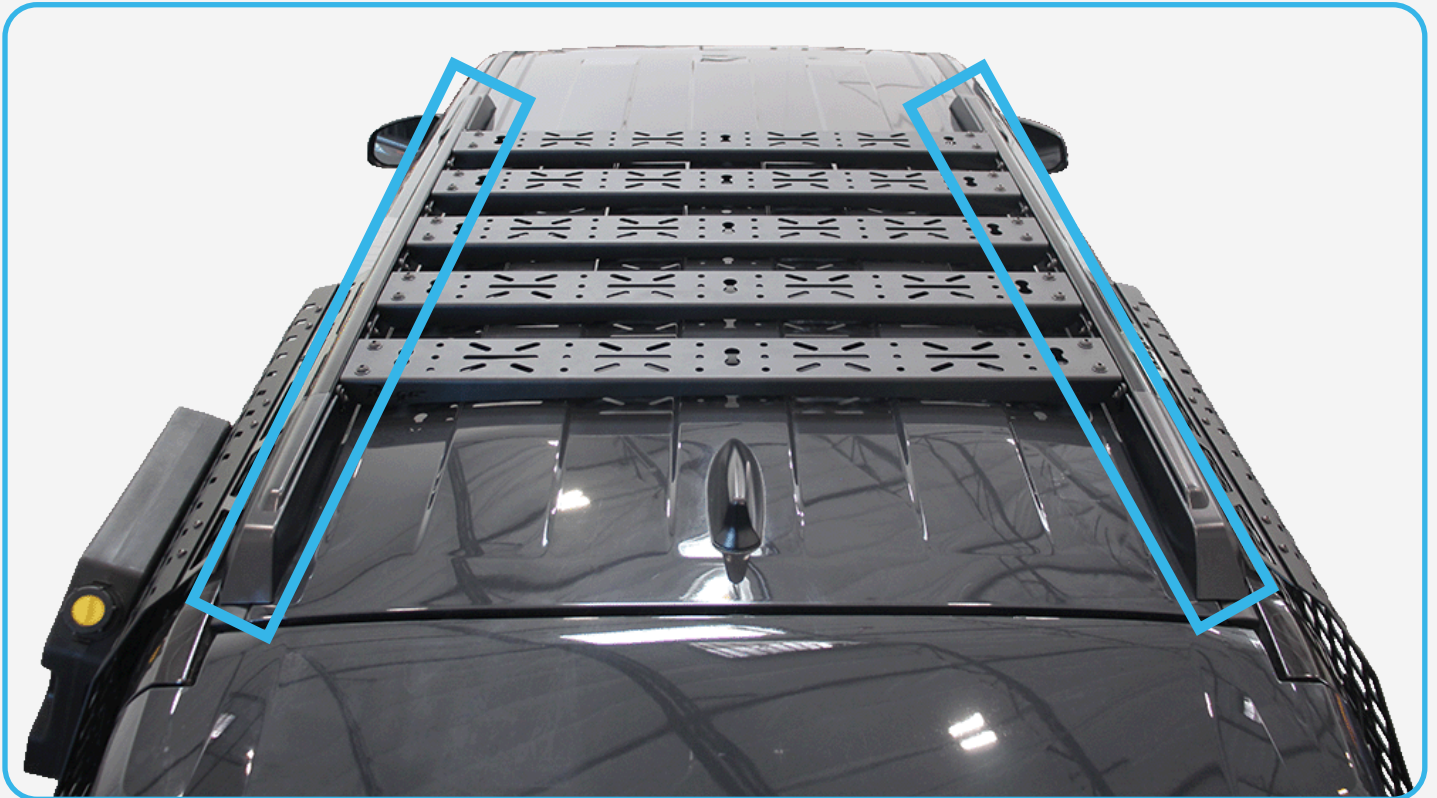



## □ STEP 14

With the cross member fully installed to the rails, fully tighten the rails to the vehicle from **step 2** and fully tighten the 3/8 hardware as shown below using a (7/32 allen). Once you are happy with the fitment, re-install the plastic covers.

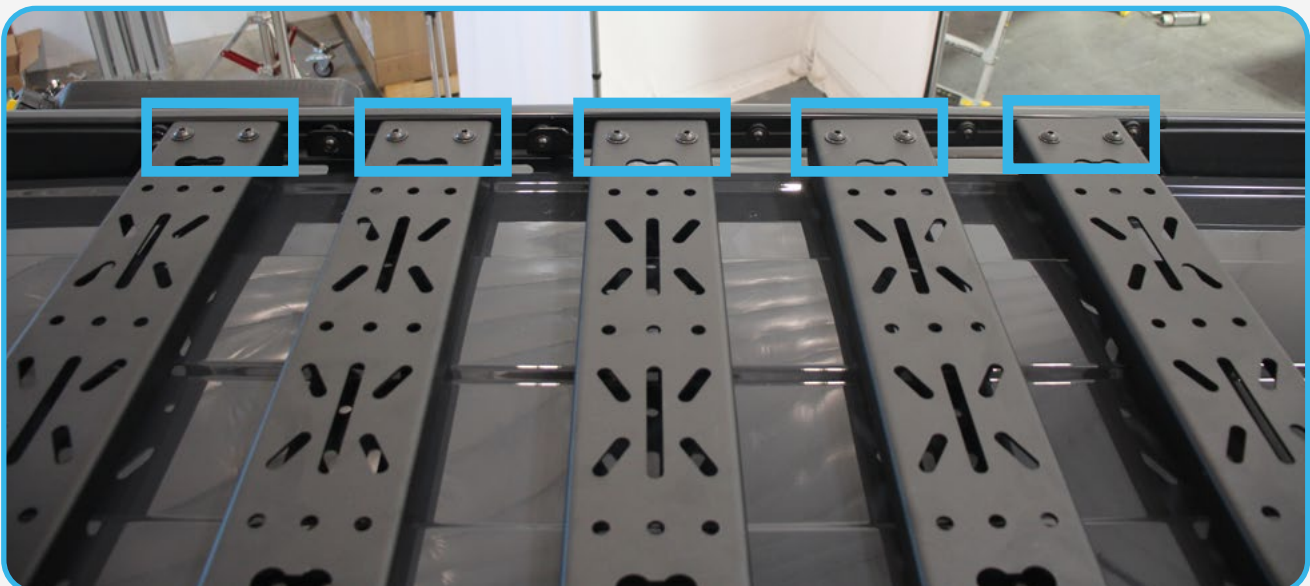



☐ **STEP 15**

Stand back and enjoy your new RAGO Cross Member Factory Roof Rails.

Check and re-tighten all mounting bolts after 100 miles and periodically thereafter.

