

DASH MOUNT

2025-UP TOYOTA 4RUNNER

AC7110901NA

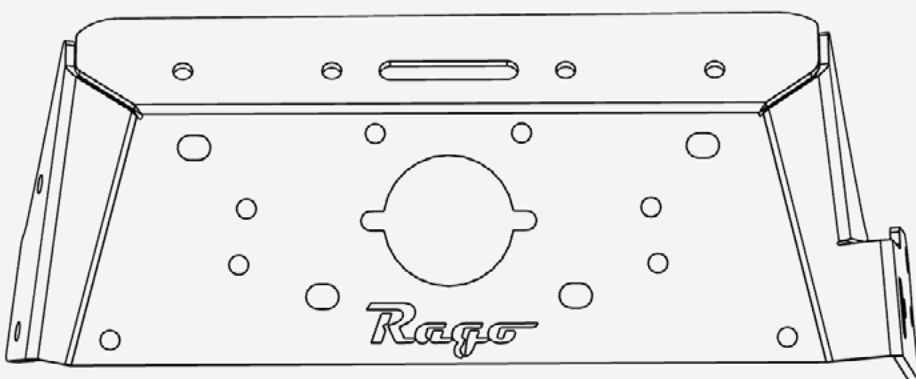
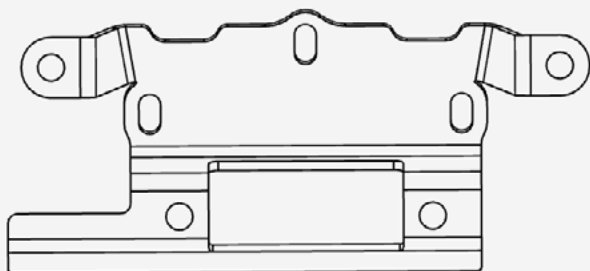

TOOLS REQUIRED

- 7/16, 11/32 Wrenches
- 9/32 Drill Bit
- 5/32 , 5/16, 5/64 Hex
- Drill



SKILL LEVEL

- Easy



TIME REQUIRED

- Approximately 45 Minutes (This installation guide covers the installation of the product only. It does not include instructions and time for wiring)

⚠ WARNINGS/CAUTIONS BEFORE STARTING INSTALLATION ⚠

-BEFORE YOU INSTALL THIS KIT-

Read and understand all instructions, warnings, cautions, & notes contained in this installation instruction guide. Consult your vehicle owner's manual for proper disconnection of electrical and lifting of vehicle if required for installation of this product.

This install may require some technical skills and knowledge of basic mechanical work. If you do not feel that you are capable of performing this install please take this product to a trained professional.

After reading this guide please contact us with any questions or concerns before installing product.

Customer Service: 830-896-7571

Rago Fabrication is not responsible for any bodily injury or harm to you or your vehicle as a result of an improper install.

Proper installation of this kit required knowledge of the factory recommended procedures for removal and installation of original equipment components.

We recommend that the factory shop manual and any special tools needed to service your vehicle be on hand during the installation. Installation of this kit without proper knowledge of the factory recommended procedures may affect the

performance of these components and the safety of the vehicle.

Inspect all contents of this package to make sure product is not damaged and all installation hardware has been included. If parts are missing from kit, please be prepared to provide the following information:

1. Name of purchase location
2. Bar Code on side of box
3. Date above bar code
4. Date inside box cover

***ALWAYS WEAR EYE PROTECTION
WHEN OPERATING POWER TOOLS***

HARDWARE

A.

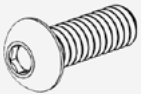

1/4-20 X 3/4" Button Head Bolt

QTY: 3

A1.



M6 Flat Washer

QTY: 5

A2.

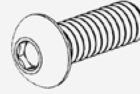

1/4-20 X 1/2" Button Head Bolt

QTY: 4

A3.



1/4-20 X 1" Button Head Bolt

QTY: 1

B.



#8-32 X 3/4" Button Head Bolt

QTY: 2

B1.



#8-32 Nylon Lock Nut

QTY: 2

C.

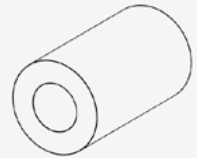

.25-1/2" Plastic Spacer

QTY: 1

D.

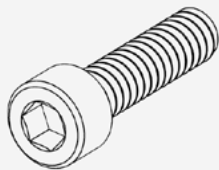

#10-24 X 3/4" Socket Head Cap Screw

QTY: 12

E.

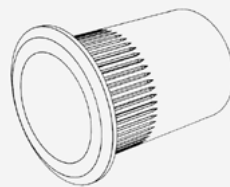

1/4-20 Rivet Nut

QTY: 4

F.

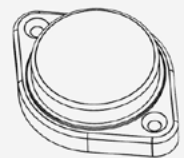

RAGO USB

QTY: 1

Reference this page throughout the install



PARTS

G.

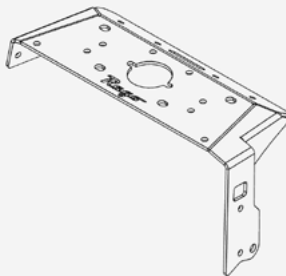

SPL0991

H.

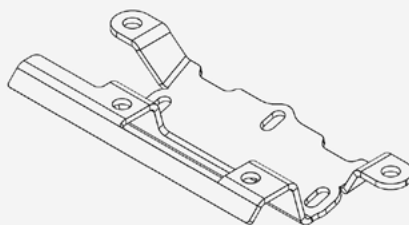

SPL0992

Reference this page throughout the install



□ STEP 1

Locate the plastic piece behind the infotainment screen.



□ STEP 2

Place the **(H)** mounting bracket on the plastic piece from **step 1**, align it on the backside of the infotainment screen using the blue dotted line as shown below. Use a marker to mark your mounting holes as shown below.



□ STEP 3

Using a pry tool remove the plastic cover as shown below.

(Use caution when removing to not damage the plastic clips)

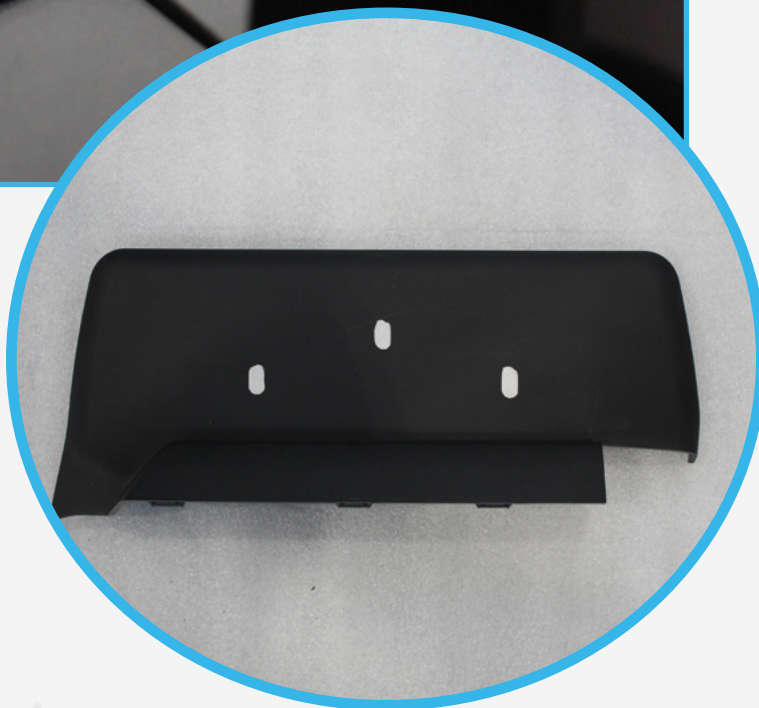

□ STEP 4

Use a (25/64 drill bit drill) to drill out the holes marked in **step 2**.

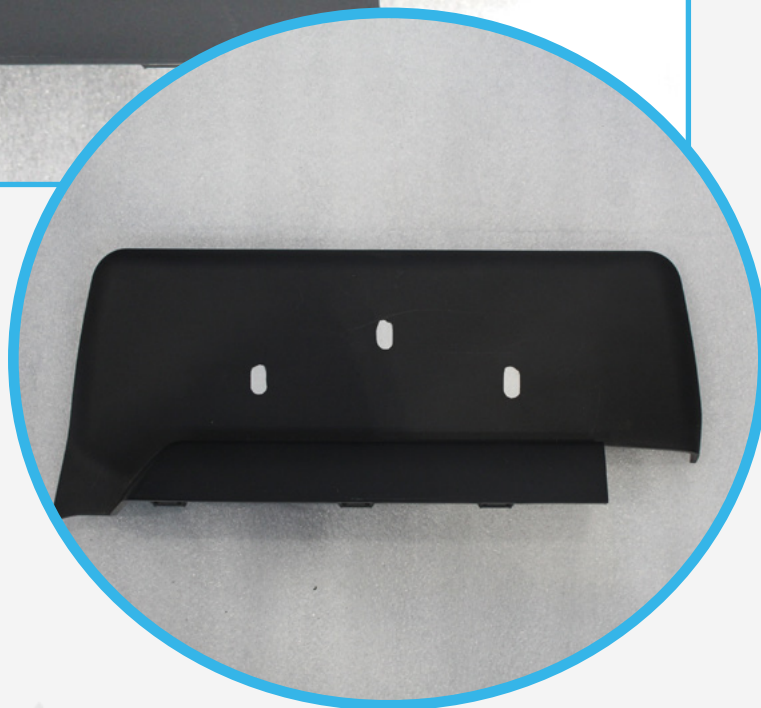

□ STEP 5

Using the **(E)** 1/4" rivet nut and a rivet nut tool, install into holes drilled in **step 3**.



□ STEP 6

If you do not have a rivet nut tool, use a 1/4-20 x 3/4 hex head bolt, a 1/4 washer, and a 3/8 nut to install the rivet nuts (E). Tighten using a (9/16 wrench) and a (7/16 socket) on a impact.

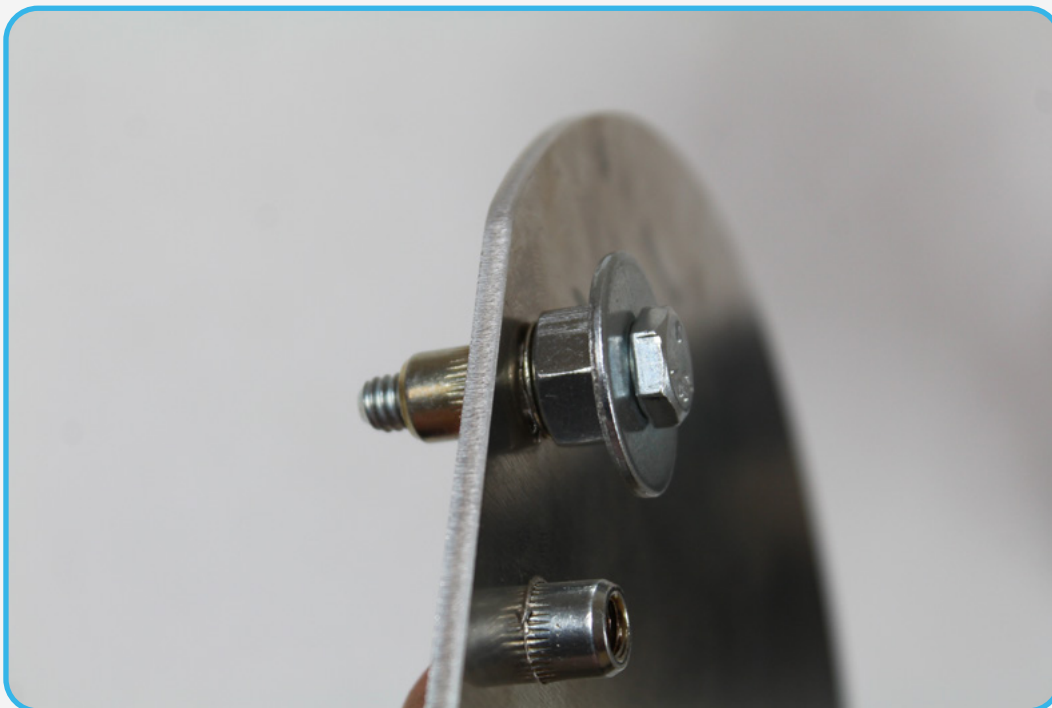

☐ STEP 7

Reinstall the plastic piece.



□ STEP 8

Install the **(H)** mounting bracket with the provided **(A, A1)** 1/4" hardware using a (5/32 allen) into the **(E)** rivet nuts installed on **step 5**.

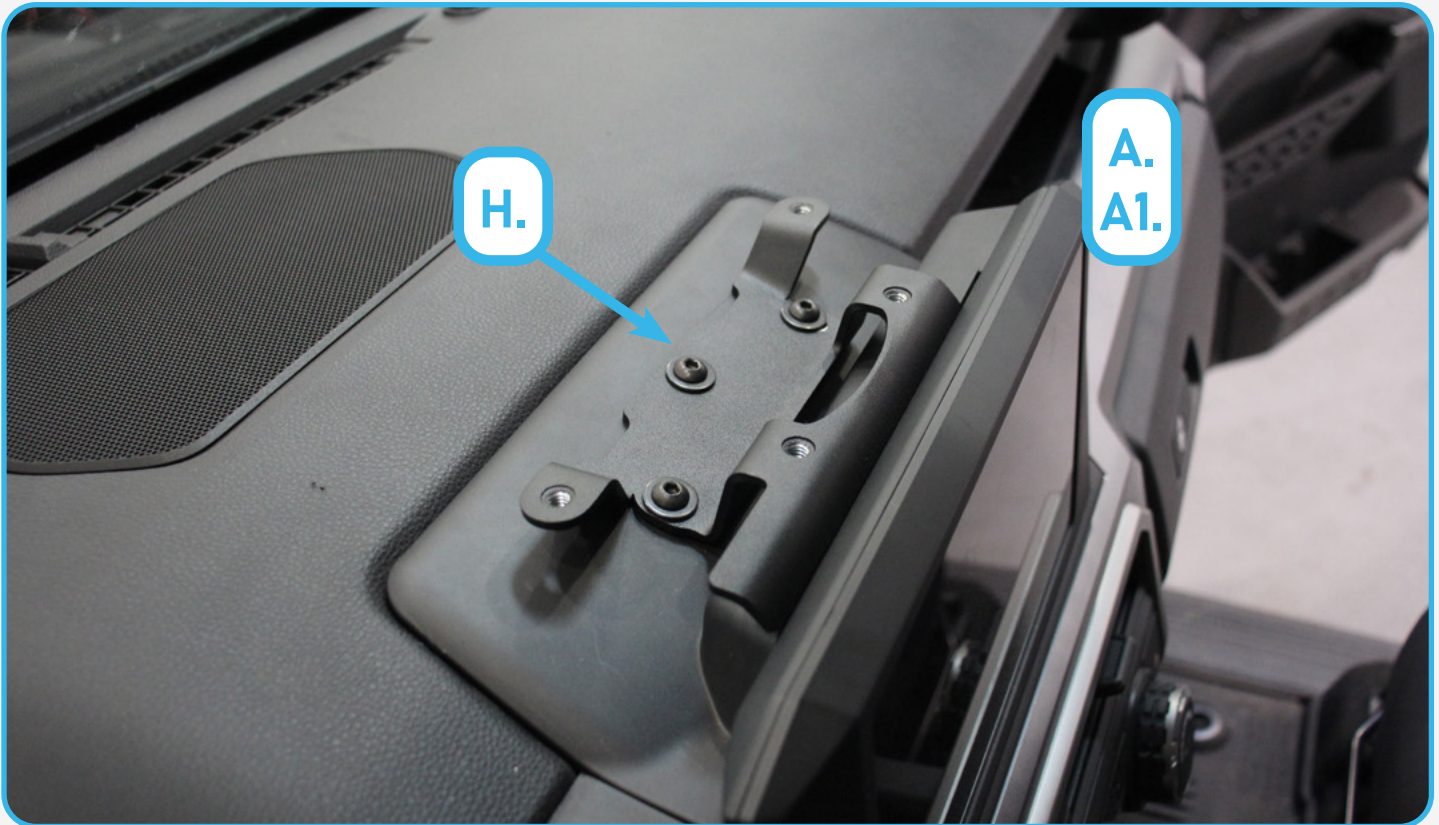

□ STEP 9

Install the provided **(F)** USB charger to the dash mount with the provided **(B, B1)** #8 hardware using a (11/32 wrench) and a (5/64 allen) as shown below. Next install the dash mount to the bracket installed on **Step 8** with the provided **(A2, A1)** hardware using a (5/32 allen).

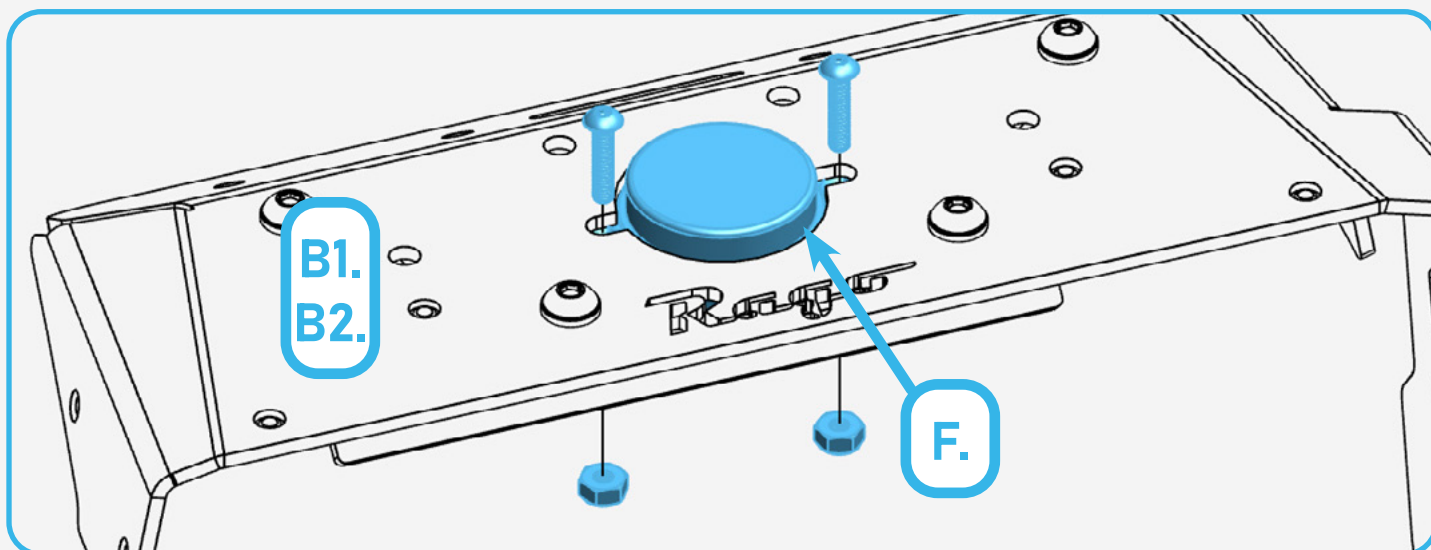

□ STEP 10

Locate the hole indicated below and mark using a marker.



□ STEP 11

Use a (25/64 drill bit) to drill out the marked area. Then install the (E) rivet nut, using the method from **step 6**



□ STEP 12

Reinstall **(G)** dash mount and use the **(A1, A3, C)** 1/4" hardware and a (5/32 allen) as shown below.



☐ STEP 13

Stand back and enjoy your new RAGO Dash Mount.

Check and re-tighten all mounting bolts after 100 miles and periodically thereafter.

