

## FACTORY ROOF RACK CROSS MEMBERS 2019-2024/SUBARU FORESTER AC8509501NA

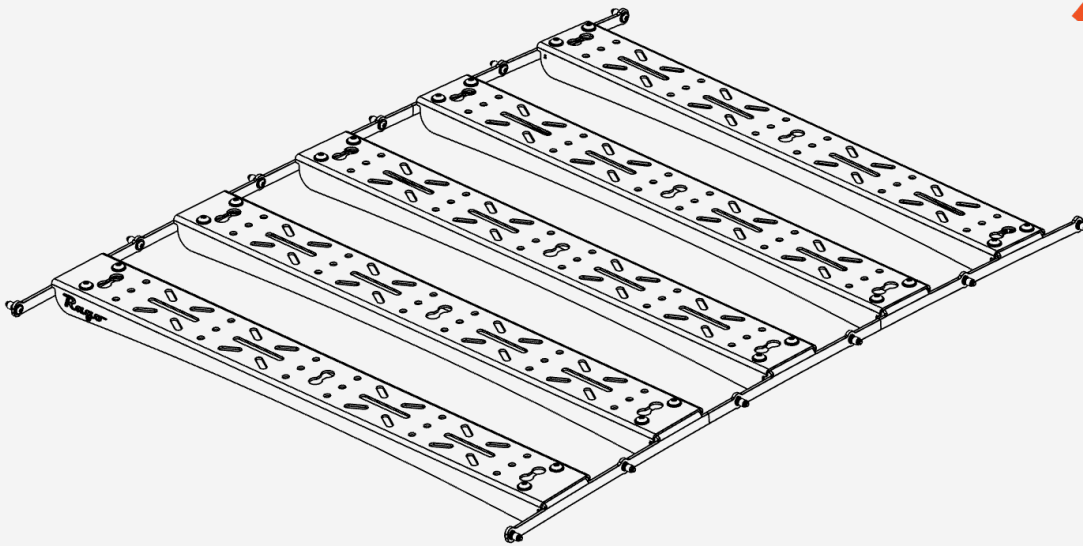

### TOOLS REQUIRED

- Rivet Nut Tool
- Step Up Drill Bit
- 5/32, 7/32 Allen
- Marker
- Tape Measure

### SKILL LEVEL

- Easy

### TIME REQUIRED

- Approximately 30 Minutes

## WARNINGS/CAUTIONS BEFORE STARTING INSTALLATION

### -BEFORE YOU INSTALL THIS KIT-

**Read and understand all instructions,** warnings, cautions, & notes contained in this installation instruction guide. Consult your vehicle owner's manual for proper disconnection of electrical and lifting of vehicle if required for installation of this product.

This install may require some technical skills and knowledge of basic mechanical work. If you do not feel that you are capable of performing this install please take this product to a trained professional.

After reading this guide please contact us with any questions or concerns before installing product.

Customer Service: 830-896-7571  
Rago Fabrication is **not** responsible for any bodily injury or harm to you or your vehicle as a result of an improper install.

Proper installation of this kit required knowledge of the factory recommended procedures for removal and installation of original equipment components.

We recommend that the factory shop manual and any special tools needed to service your vehicle be on hand during the installation. Installation of this kit without proper knowledge of the factory recommended procedures may affect the

performance of these components and the safety of the vehicle. Inspect all contents of this package to make sure product is not damaged and all installation hardware has been included. If parts are missing from kit, please be prepared to provide the following information:

1. Name of purchase location
2. Bar Code on side of box
3. Date above bar code
4. Date inside box cover

**\*ALWAYS WEAR EYE PROTECTION  
WHEN OPERATING POWER TOOLS\***

## HARDWARE

**A.**

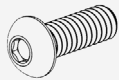

1/4-20 X 3/4" BUTTON HEAD BOLT

**QTY: 12**

**A1.**



M6 FLAT WASHER

**QTY: 12**

**A2.**

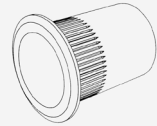

1/4-20 RIVET NUT

**QTY: 12**

**B.**

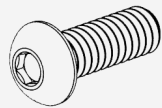

3/8-16 X 3/4" BUTTON HEAD BOLT

**QTY: 20**

**B1.**



3/8" FLAT WASHER

**QTY: 20**



## □ STEP 1

Measuring off the front of the roof rack as shown below mark the center of the roof rail.

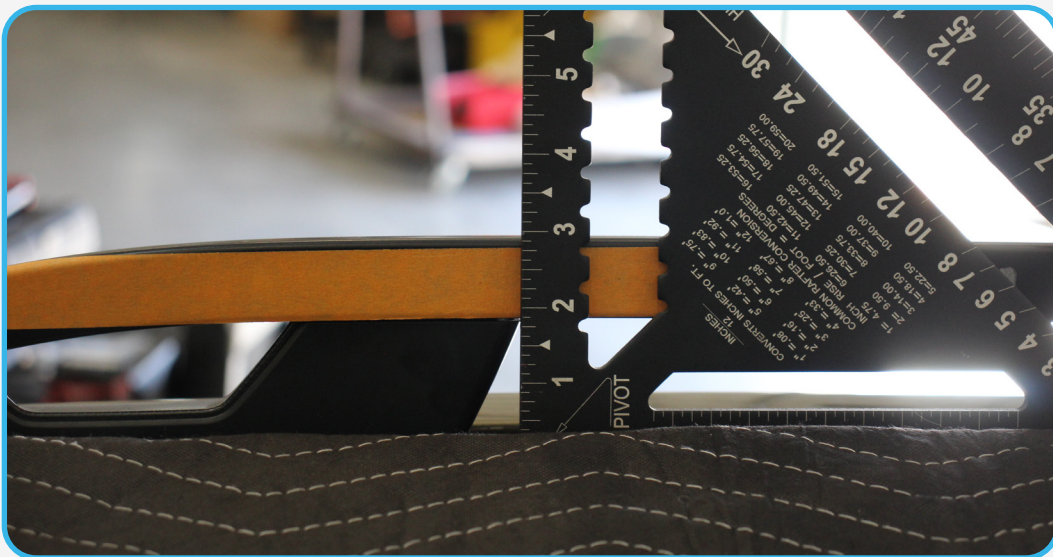
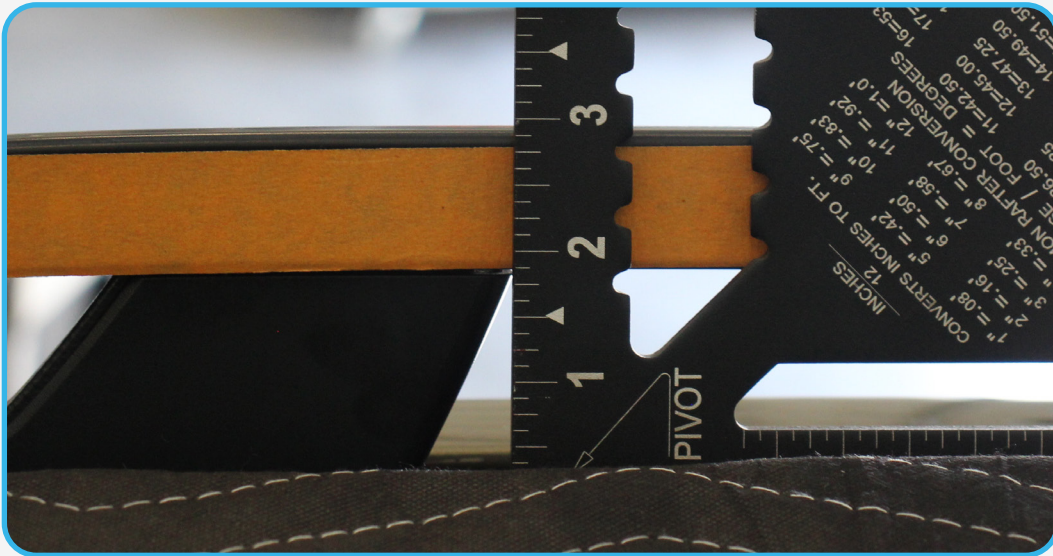

## □ STEP 2

Measure 2 3/8" from the point marked in step 1 and drill out to a 7/16 hole using a step up bit.



## □ STEP 3

Install the provided rivet nut (A2). Then secure the cross member mounting rail using the provided 1/4 hardware (A, A1) and a 5/32 allen.

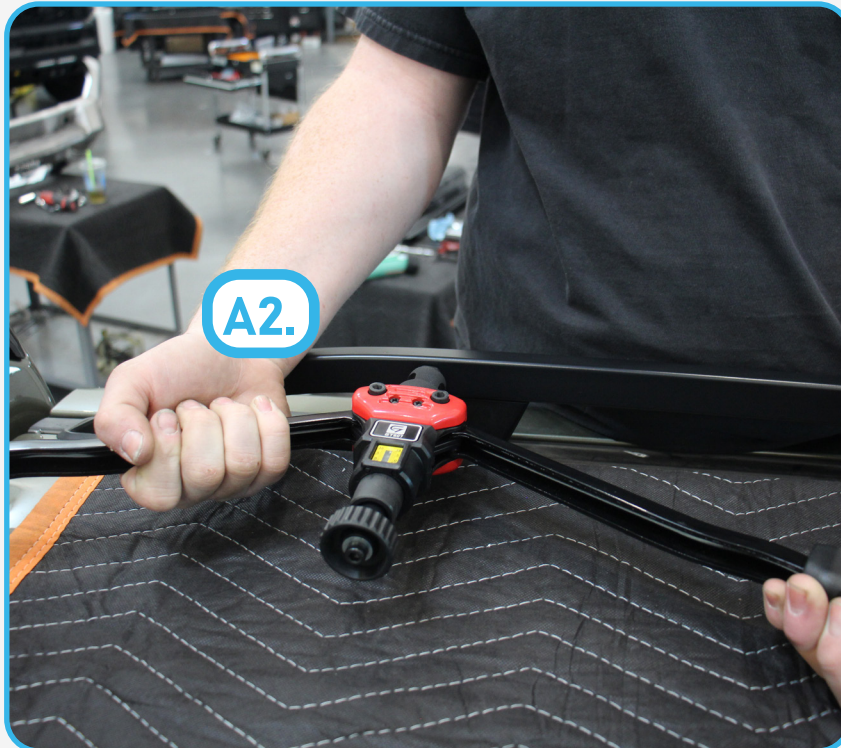

## □ STEP 4

Clamp the mounting rail to the roof rail, then measure down 1/2" and mark all mounting holes. Use a step up bit to drill a 7/16 hole, then install the provided 1/4" rivet nuts (A2).

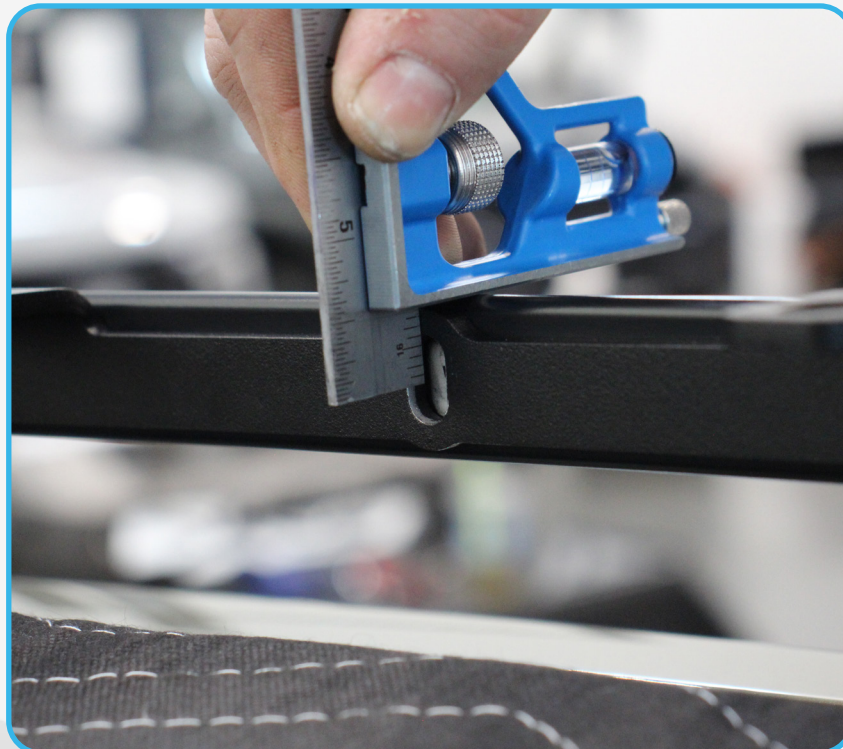
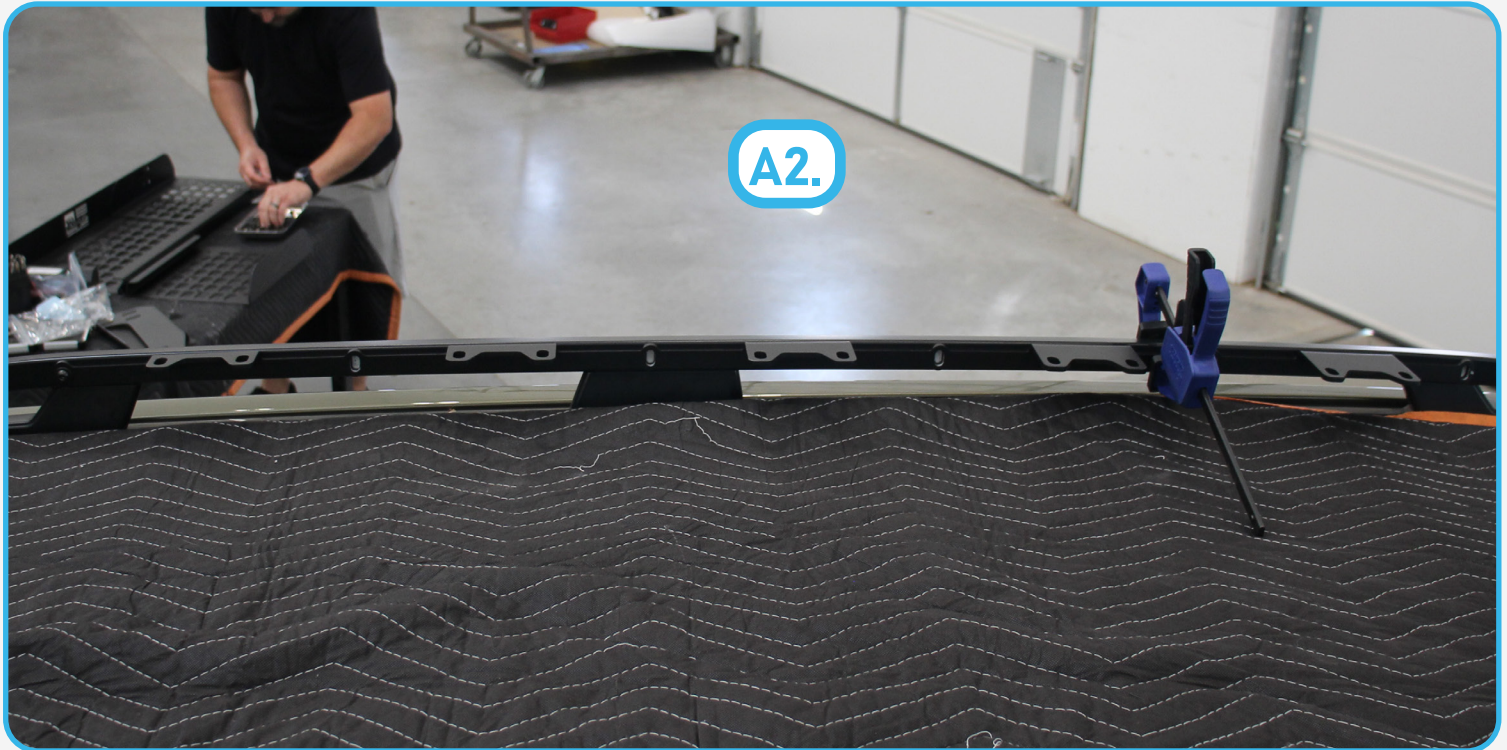

## □ STEP 5

Install the mounting rail using the provided 1/4" hardware (A, A1) and a 5/32 allen.

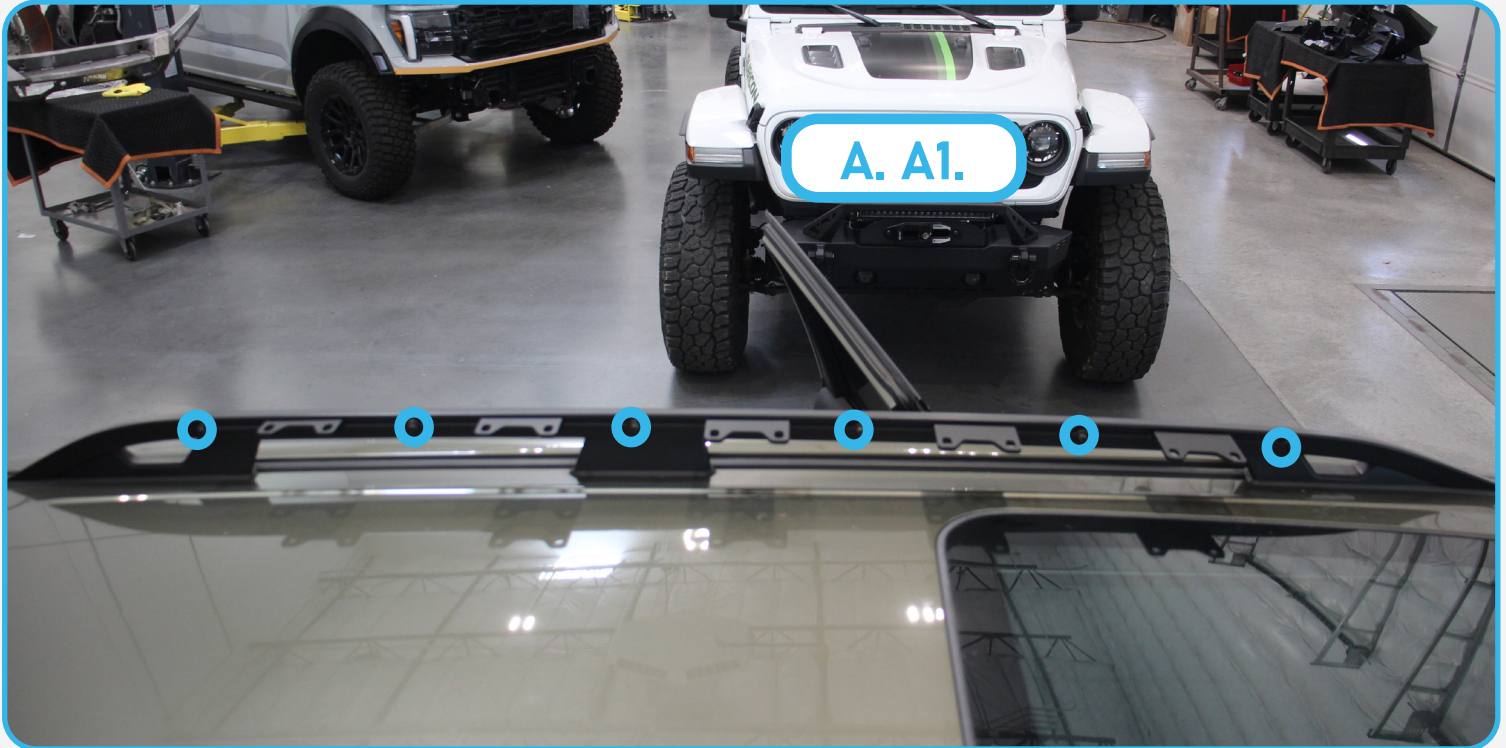

## □ STEP 6

Using the provided nut plate slip it under the factory cross members and secure it with the provided 3/8" hardware (B, B1) and a 7/32 allen.

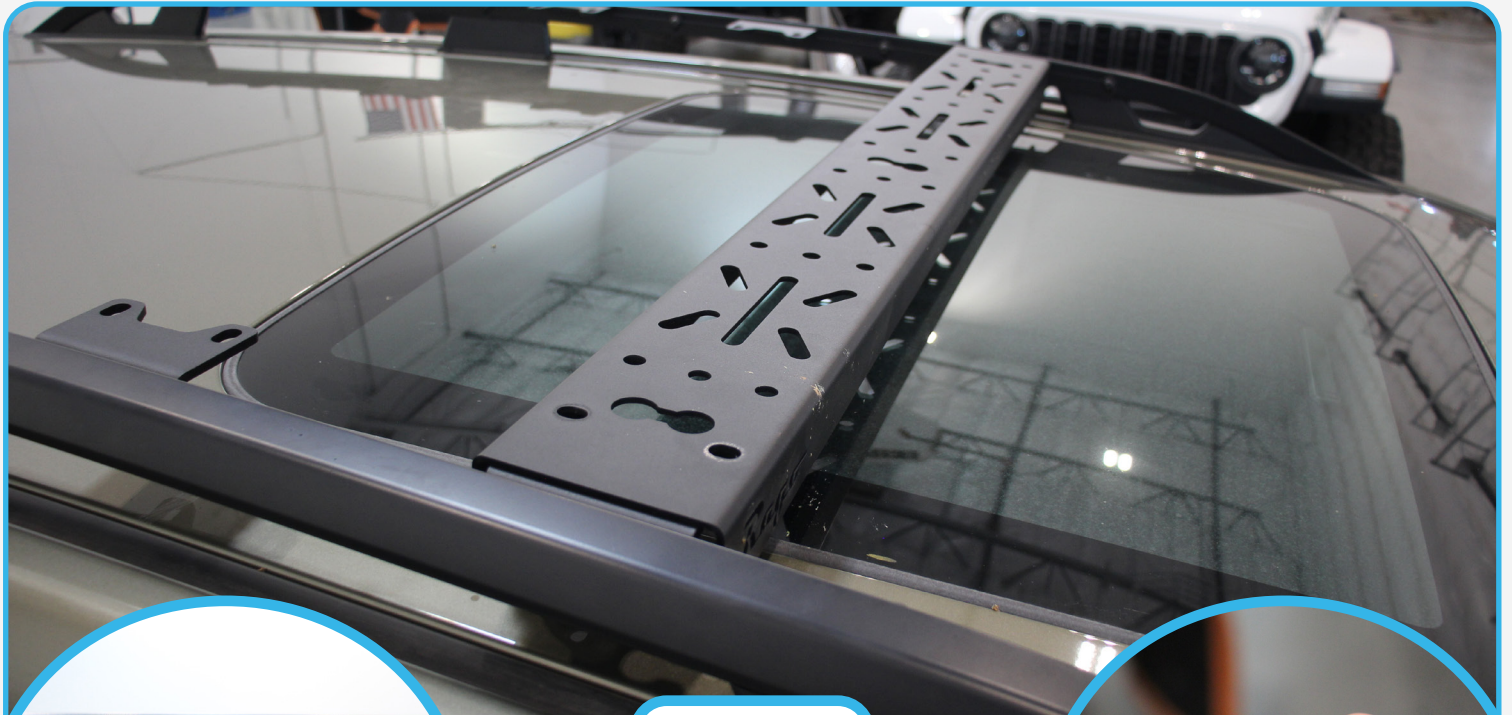

**B. B1.**

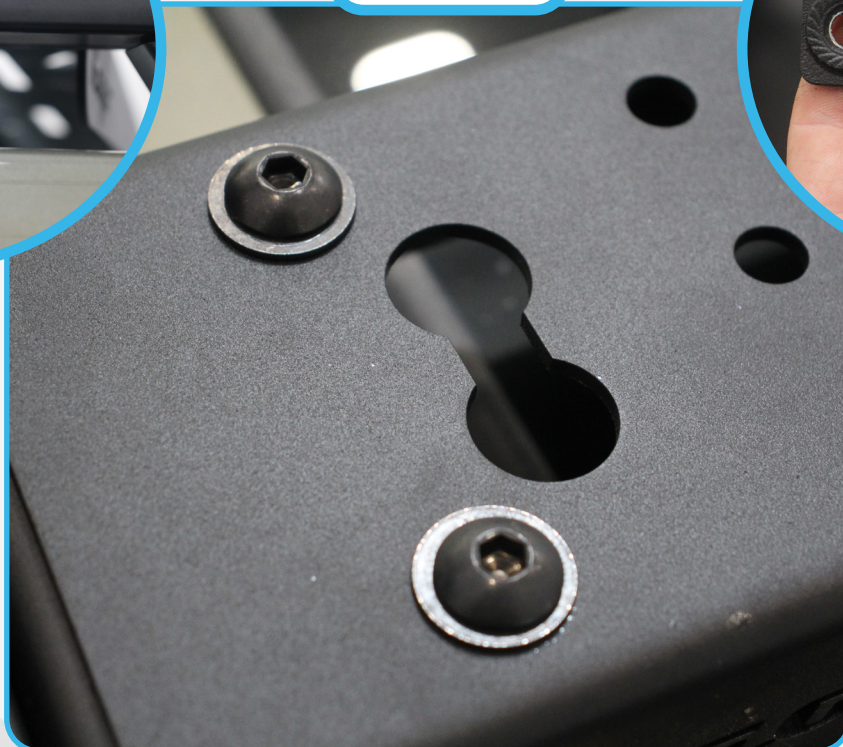

## STEP 7

Stand back and enjoy your new RAGO Factory Roof Rack Cross members

Check and re-tighten all mounting bolts after 100 miles and periodically thereafter.

